

NET PRICES EURO - JANUARY 2025

Exterior Street/Park luminaires



Way
page 2-4
Way top
page 5-6



Peak 380
page 7
Peak 320
page 8



Nyx 330
page 9-10



Nyx 450
page 11



Space
page 14



Sky Park
page 15



Sticks 3000
page 17



Dua High
page 19



Turn Street
Turn Spot
page 12



Turn Gobo
page 13

Exterior Bollards



Sky Bollard
page 16



Sticks 900
page 17



Nyx Bollard
page 22



Dua Bollard
Dua Low
page 18



Tema Bollard
page 20

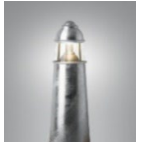

Pharos
page 21

Interior/Exterior Wall



Sky Wall
page 14



Pelée Wall
page 42



Nyx 190
Nyx 330
page 23-24



Quarto 270
Quarto 380
page 25-27



Square 190
Square 250
Square 270
page 28-31



Stoa
page 32



Tema Buen
page 33

Interior Downlights



Yoyo
page 34-35



Pelée
page 39-40



Pelée
Downlight
page 41



H+M
page 46-47



Punkt Lamp
page 49-50

Interior Suspended



Yoyo Pendant
page 36



Pelée Pendant
page 41



Yoyo Line
page 37



Pelée Line
page 43-45



H+M Pendant
page 48

Yoyo Outdoor
page 38

LED modules: page 51-52
Poles: page 53-59
Colours: page 60
Sales and delivery terms: page 61

The prices quoted in this price list are excl. VAT, duty and any other taxes.

Prices can be changed without notice. Please see terms enclosed.

FOCUS-LIGHTING

WAY SIDE ENTRY, Ø48



Side entry Ø48, FF-DA board with T3 lenses for local roads, P, HS, and C classes			
Item No.	Definition	Net price excl. VAT	EUR
9810-	LED 3xFF-DA, T3, programmable, 10.5 m lead		823
9812-	LED 4xFF-DA, T3, programmable, 10.5 m lead		916

Side entry Ø48, FF-DA board with MEW lenses for traffic roads, M classes			
Item No.	Definition	Net price excl. VAT	EUR
9815-	LED 3xFF-DA, MEW, programmable, 10.5 m lead		823
9816-	LED 4xFF-DA, MEW, programmable, 10.5 m lead		916

Side entry Ø48, FF-DA board with T4 lenses for roundabouts and wide roads			
Item No.	Definition	Net price excl. VAT	EUR
9813-	LED 3xFF-DA, T4, programmable, 10.5 m lead		823
9814-	LED 4xFF-DA, T4, programmable, 10.5 m lead		916

Side entry Ø48, FF-DA board with PX lenses for pedestrian crossings			
Item No.	Definition	Net price excl. VAT	EUR
9817-	LED 3xFF-DA, PX, programmable, 10.5 m lead		823
9818-	LED 4xFF-DA, PX, programmable, 10.5 m lead		916

Select colour, colour temperature, etc in the table below and construct the order code as shown below.							
Colour	Price	Colour temperature	Price	Control/Dimming	Price	Protection class	Price
01 = raw anodized	0	730 = 3000 K, 70 Ra	0	empty = programmable	0	empty = class II	0
4 = graphite grey	0	740 = 4000 K, 70 Ra	0	D = DALI-2	0	J = class I	0
9 = silver grey	0	827* = 2700 K, 80 Ra	0	F = LineSwitch	0		
17 = corten brown	0	830* = 3000 K, 80 Ra	0	R = Zhaga socket up, D4i	134	N = Halogen-free cable	13
66 = noir 900	0	840* = 4000 K, 80 Ra	0	RC = CityTch/InteractCity, D4i	134	X = Varistor 10 kV	54
Other RAL colours	67	* Longer lead times		S = Zhaga socket down, D4i	67		
				RS = Zhaga sockets up/down,	168		
Corrosion coating			Price				
C5 = C5 coating			81				
Add C5 after the colour code. Example: 9810-9C5730							
Example product code: 9810-9730J = Way side entry Ø48, 3xFF, T3 lenses, silver grey, 3000K 70 Ra, cl. I							
See lumen packages in the Way specs at focus-lighting.dk							

WAY SIDE ENTRY, Ø60

Side entry Ø60, FF-DA board with T3 lenses for local roads, P, HS, and C classes			
Item No.	Definition	Net price excl. VAT	EUR
9870-	LED 3xFF-DA, T3, programmable, 10.5 m lead		823
9872-	LED 4xFF-DA, T3, programmable, 10.5 m lead		916

Side entry Ø60, FF-DA board with MEW lenses for traffic roads, M classes			
Item No.	Definition	Net price excl. VAT	EUR
9875-	LED 3xFF-DA, MEW, programmable, 10.5 m lead		823
9876-	LED 4xFF-DA, MEW, programmable, 10.5 m lead		916

Side entry Ø60, FF-DA board with T4 lenses for roundabouts and wide roads			
Item No.	Definition	Net price excl. VAT	EUR
9873-	LED 3xFF-DA, T4, programmable, 10.5 m lead		823
9874-	LED 4xFF-DA, T4, programmable, 10.5 m lead		916

Side entry Ø60, FF-DA board with PX lenses for pedestrian crossings			
Item No.	Definition	Net price excl. VAT	EUR
9877-	LED 3xFF-DA, PX, programmable, 10.5 m lead		823
9878-	LED 4xFF-DA, PX, programmable, 10.5 m lead		916

Select colour, colour temperature, etc in the table below and construct the order code as shown below.							
Colour	Price	Colour temperature	Price	Control/Dimming	Price	Protection class	Price
01 = raw anodized	0	730 = 3000 K, 70 Ra	0	empty = programmable	0	empty = class II	0
4 = graphite grey	0	740 = 4000 K, 70 Ra	0	D = DALI-2	0	J = class I	0
9 = silver grey	0	827* = 2700 K, 80 Ra	0	F = LineSwitch	0		
17 = corten brown	0	830* = 3000 K, 80 Ra	0	R = Zhaga socket up, D4i	134	N = Halogen-free cable	13
66 = noir 900	0	840* = 4000 K, 80 Ra	0	RC = CityTch/InteractCity, D4i	134	X = Varistor 10 kV	54
Other RAL colours	67	* Longer lead times		S = Zhaga socket down, D4i	67		
				RS = Zhaga sockets up/down,	168		
Corrosion coating			Price				
C5 = C5 coating			81				
Add C5 after the colour code. Example: 9810-9C5730							

Example product code: 9870-9730J = Way side entry Ø60, 3xFF, T3 lenses, silver grey, 3000K 70 Ra, cl. I
See lumen packages in the Way specs at focus-lighting.dk

WAY PARK



Side entry Ø48, circular board with diffuser			
Item No.	Definition	Net price excl. VAT	EUR
9808-	LED Ø240, programmable, 10.5 m lead		976

Side entry Ø60, circular board with diffuser			
Item No.	Definition	Net price excl. VAT	EUR
9908-	LED Ø240, programmable, 10.5 m lead		976

Select colour, colour temperature, etc in the table below and construct the order code as shown below.							
Colour	Price	Colour temperature	Price	Control/Dimming	Price	Protection class	Price
01 = raw anodized	0	830 = 3000 K, 80 Ra	0	empty = programmable	0	empty = class II	0
4 = graphite grey	0	840 = 4000 K, 80 Ra	0	D = DALI-2	0	J = class I	0
9 = silver grey	0			F = LineSwitch	0		
17 = corten brown	0			R = Zhaga socket up, D4i	134	N= Halogen-free cable:	13
66 = noir 900	0			RC = CityTch/InteractCity, D4i	134	X = Varistor 10 kV	54
Other RAL colours	67			S = Zhaga socket down, D4i	67		
				RS = Zhaga sockets up/down,	168		
Corrosion coating			Price				
C5 = C5 coating			81				
Add C5 after the colour code. Example: 9810-9C5730							

Example product code: 9808-66830J = Way Park, circular board, noir 900, 3000K 80 Ra, class I
See lumen packages in the Way specs at focus-lighting.dk

WAY TOP ENTRY

The luminaire is supplied with the lead length ordered.



Top entry, FF-DA with T3 symmetric lenses			
Item No.	Definition	Net price excl. VAT	EUR
9850-	LED 3xFF-DA, T3, programmable		823
9888-	LED 4xFF-DA, T3, programmable		916

Top entry, FF-DA with MEW symmetric lenses			
Item No.	Definition	Net price excl. VAT	EUR
9854-	LED 3xFF-DA, MEW, programmable		823
9889-	LED 4xFF-DA, MEW, programmable		916

Top entry, FF-DA board with CAT lenses			
Item No.	Definition	Net price excl. VAT	EUR
9856-	LED 3xFF-DA, CAT, programmable		823
9890-	LED 4xFF-DA, CAT, programmable		916

Select colour, colour temperature, and lead in the table below and construct the order code as shown below.							
Colour	Price	Colour temperature	Price	Lead	Price	Control/Dimming	Price
01 = raw anodized	0	730 = 3000 K, 70 Ra	0	2 = 2 pcs 2 m 1x2.5 mm ²	0	empty = programmable	0
4 = graphite grey	0	740 = 4000 K, 70 Ra	0	10 = 1 pcs 10 m 2x1 mm ²	0	D = DALI-2	0
9 = silver grey	0	827* = 2700 K, 80 Ra	0			F = LineSwitch	0
17 = corten brown	0	830* = 3000 K, 80 Ra	0			R = Zhaga socket up, D4i	134
66 = noir 900	0	840* = 4000 K, 80 Ra	0			RC = CityTch/InteractCity, D4i	134
Other RAL colours	67	* Longer lead times				S = Zhaga socket down, D4i	67
						RS = Zhaga sockets up/down, D4i	168
Protection class	Price						
empty = class II	0					X = Varistor 10 kV	54
J = class I	0						

Corrosion coating	Price
C5 = C5 coating	81
Add C5 after the colour code. Example: 9850-9C5730	

Example: 9850-98302J = Way, top entry, 3x FF-DA board, T3 lenses, silver grey, 3000K 80 Ra, 2 m lead, class I
See lumen packages in the Way specs at focus-lighting.dk

OPTIONAL COMPONENTS

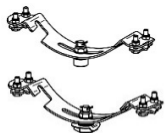

Product code	Type	Net price excl. VAT	EUR
1715-0	Wire hanger for suspension in single wire		134
1716-0	Wire hanger for suspension in single wire, Way with Zhaga socket		134
1717-0	Fittings for top mounting of Way with Zhaga socket		16
1718-0	Connection box, class II		27

WAY TOP ENTRY

The luminaire is supplied with the lead length ordered.



Top entry, circular LED board with CAT lenses			
Item No.	Definition	Net price excl. VAT	EUR
9801-	LED Ø240, Low lumen, programmable		976
9802-	LED Ø240, High lumen, programmable		976

Select colour, colour temperature, and lead in the table below and construct the order code as shown below.

Colour	Price	Colour temperature	Price	Lead	Price	Control/Dimming	Price
01 = raw anodized	0	830 = 3000 K, 80 Ra	0	2 = 2 pcs 2 m 1x2.5 mm2	0	empty = programmable	0
4 = graphite grey	0	840 = 4000 K, 80 Ra	0	10 = 1 pcs 10 m 2x1 mm2	0	D = DALI-2	0
9 = silver grey	0					F = LineSwitch	0
17 = corten brown	0			N= Halogen-free cables	13	R = Zhaga socket up, D4i	134
66 = noir 900	0					RC = CityTch/InteractCity, D4i	134
Other RAL colours	67					S = Zhaga socket down, D4i	67
						RS = Zhaga sockets up/down, D4i	168
Protection class	Price						
empty = class II	0					X = Varistor 10 kV	54
J = class I	0						

Corrosion coating	Price
C5 = C5 coating	81
Add C5 after the colour code. Example: 9801-9C5830	

Example: 9801-98302J = Way, top entry, circular board, CAT lenses, silver grey, 3000K 80 Ra, 2 m lead, class I

See lumen packages in the Way specs at focus-lighting.dk

OPTIONAL COMPONENTS

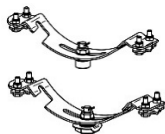

Product code	Type	Net price excl. VAT	EUR
1715-0	Wire hanger for suspension in single wire		134
1716-0	Wire hanger for suspension in single wire, Way with Zhaga socket		134
1717-0	Fittings for top mounting of Way with Zhaga socket		16
1718-0	Connection box, class II		27

PEAK 380

The luminaire is supplied with 8.5 m lead for post top, + 2 meter in case of side entry.



Ø 380 mm, FF-DA board with T3 lenses for local roads, P, HS, and C classes			
Product code	Definition	Net price excl. VAT	EUR
8950-	LED 1xFF-DA, T3, programmable, 8.5 m lead		701
8951-	LED 2xFF-DA, T3, programmable, 8.5 m lead		792
8952-	LED 3xFF-DA, T3, programmable, 8.5 m lead		884

Ø 380 mm, FF-DA board with MEW lenses for traffic roads, M classes			
Product code	Definition	Net price excl. VAT	EUR
8970-	LED 1xFF-DA, MEW, programmable, 8.5 m lead		701
8971-	LED 2xFF-DA, MEW, programmable, 8.5 m lead		792
8973-	LED 3xFF-DA, MEW, programmable, 8.5 m lead		884

Ø 380 mm, FF-DA board with T4 lenses for roundabouts and wide roads			
Product code	Definition	Net price excl. VAT	EUR
8955-	LED 1xFF-DA, T4, programmable, 8.5 m lead		701
8956-	LED 2xFF-DA, T4, programmable, 8.5 m lead		792
8957-	LED 3xFF-DA, T4, programmable, 8.5 m lead		884

Ø 380 mm, FF-DA board with PX lenses for pedestrian crossings			
Product code	Definition	Net price excl. VAT	EUR
8980-	LED 1xFF-DA, PX, programmable, 8.5 m lead		701
8981-	LED 2xFF-DA, PX, programmable, 8.5 m lead		792
8982-	LED 3xFF-DA, PX, programmable, 8.5 m lead		884

Select colour, colour temperature, and mounting in the table below and construct the order code as shown below.							
Colour	Price	Colour temperature	Price	Mounting	Price	Control/Dimming	Price
01 = raw anodized	0	730 = 3000 K, 70 Ra	0	T = post top	0	empty = programmed	0
4 = graphite grey	0	740 = 4000 K, 70 Ra	0	U = side entry	0	D = DALI-2	0
9 = silver grey	0	827* = 2700 K, 80 Ra	0	G = mid-post housing	148	F = LineSwitch	0
66 = noir 900	0	830* = 3000 K, 80 Ra	0	G76 = mid-post Ø76	148	R = Zhaga socket up, D4i	67
Other RAL colours	67	840* = 4000 K, 80 Ra	0			RC = CityTch/InteractCity, D4i	67
		* Longer lead times				S = Zhaga socket down, D4i	67
Protection class	Price					RS = Zhaga sockets up/down, D	94
empty = class II	0						
J = class I	0					N = Halogen-free cables	13
						X = Varistor 10 kV	54
Corrosion coating			Price				
C5 = C5 coating			81				
Add C5 after the colour code. Example: 8951-9C5730							

Example product code: 8951-9730TJ = Peak 380, 2xFF-DA, T3, silver grey, 3000K 70 Ra, post top, class I
 See lumen packages in the Peak specs at focus-lighting.dk

PEAK 320

The luminaire is supplied with 6.5 m lead for post top, + 2 meter in case of side entry.



Peak 320, with T3 lenses for local roads			
Product code	Definition	Net price excl. VAT	EUR
8710-	LED 1xFF-DA 2x6, T3, Low lumen, programmable, 5.5 m lead		524
8711-	LED 1xFF-DA 2x6, T3, High lumen, programmable, 5.5 m lead		524

Peak 320, with SCL lenses			
Product code	Definition	Net price excl. VAT	EUR
8712-	LED 1xFF-DA 2x6, SCL, Low lumen, programmable, 5.5 m lead		524
8713-	LED 1xFF-DA 2x6, SCL, High lumen, programmable, 5.5 m lead		524

Peak 320, with MEW lenses for traffic roads			
Product code	Definition	Net price excl. VAT	EUR
8714-	LED 1xFF-DA 2x6, MEW, Low lumen, programmable, 5.5 m lead		524
8715-	LED 1xFF-DA 2x6, MEW, High lumen, programmable, 5.5 m lead		524

Select colour, colour temperature, and mounting in the table below and construct the order code as shown below.							
Colour	Price	Colour temperature	Price	Mounting	Price	Control/Dimming	Price
01 = raw anodized	0	722 = 2200 K, 70 Ra	0	T = post top	0	empty = programmed	0
4 = graphite grey	0	730 = 3000 K, 70 Ra	0	U = side entry	0	D = DALI-2	0
9 = silver grey	0	740 = 4000 K, 70 Ra	0			F = LineSwitch	0
Other RAL colours	67	827 = 2700 K, 80 Ra	0			R = Zhaga socket up, D4i	67
		830 = 3000 K, 80 Ra	0			RC = CityTch/InteractCity, D4i	67
						S = Zhaga socket down, D4i	67
Protection class	Price					RS = Zhaga sockets up/down, D4i	94
empty = class II	0						
J = class I	0					N = Halogen-free cables	13
						X = Varistor 10 kV	54
Corrosion coating			Price				
C5 = C5 coating			81				
Add C5 after the colour code. Example: 8951-9C5730							
Example: 8710-9730T = Peak 320, 1xFF-DA 6x2, low lumen, T3, silver, 3000K 70 Ra, Top mount, class II							
See lumen packages in the Peak specs at focus-lighting.dk							

NYX 330 POLE TOP

The luminaire is supplied with 5.5 m lead, 2 x 1 mm².



Ø 330 mm, LED FF-DA board with T3 lenses for local roads, P, HS, and C classes			
Product code	Definition	Net price excl. VAT	EUR
8914-	1xFF-DA, T3, High lumen, programmable, 5.5 m lead		670
8918-	1xFF-DA, T3, Low lumen, programmable, 5.5 m lead		670

Ø 330 mm, LED FF-DA board with SCL lenses for pathways			
Product code	Definition	Net price excl. VAT	EUR
8913-	1xFF-DA, SCL, High lumen, programmable, 5.5 m lead		670
8919-	1xFF-DA, SCL, Low lumen, programmable, 5.5 m lead		670

Select colour, colour temperature, lead length etc. in the table below and construct the order code as shown below.

Colour	Price	Colour temperature	Price	Control/Dimming	Price	Protection class	Price
01 = raw anodized	0	730 = 3000 K, 70 Ra	0	empty = programmed	0	empty = class II	0
3 = black RAL 9005	0	740 = 4000 K, 70 Ra	0	D = DALI-2	0	J = class I	0
4 = graphite grey	0	827* = 2700 K, 80 Ra	0	F = LineSwitch	0		
9 = silver grey	0	830* = 3000 K, 80 Ra	0	R = Zhaga socket up, D4i	67	N= Halogen-free ca	13
17 = corten brown	0	840* = 4000 K, 80 Ra	0	RC = CityTch/InteractCity, D4i	67	X = Varistor 10 kV	54
66 = black noir 900	0	* Longer lead times		S = Zhaga socket down, D4i	67		
Other RAL colours	67			RS = Zhaga sockets up/down, D	94		
Corrosion coating			Price				
C5 = C5 coating			81				

Add C5 after the colour code. Example: 8914-9C5730

Example Order code: 8914-9730J = Nyx 330 FF-DA, T3, High lumen, silver grey, 3000K, 70 Ra, class I
 See lumen packages in the Nyx specs at focus-lighting.dk



Ø 330 mm, LED Comfort with programmable driver			
Product code	Definition	Net price excl. VAT	EUR
8910-	LED Comfort, programmable, 5.5 m lead		610

Select colour, colour temperature, lead length etc. in the table below. Penetrated housing: see below.

Colour	Price	Colour temperature	Price	Control/Dimming	Price	Protection class	Price
01 = raw anodized	0	827 = 2700 K, 80 Ra	0	empty = programmed	0	empty = class II	0
3 = black RAL 9005	0	830 = 3000 K, 80 Ra	0	D = DALI-2	0	J = class I	0
4 = graphite grey	0	840 = 4000 K, 80 Ra	0	F = LineSwitch	0		
9 = silver grey	0	730 = 3000 K, 70 Ra	0	R = Zhaga socket up, D4i	67	Screen type	Price
17 = corten brown	0	740 = 4000 K, 70 Ra	0	RC = CityTch/InteractCity, D4i	67	empty = frosted	0
66 = black noir 900	0			S = Zhaga socket down, D4i	67	O = opal-white	0
Other RAL colours	67			RS = Zhaga sockets up/down, D	94		
						N= Halogen-free ca	13
Corrosion coating			Price				
C5 = C5 coating			81				

Add C5 after the colour code. Example: 8914-9C5730

Example Order code: 8910-9830JG = Nyx 330 Comfort, silver grey, 3000K 80 Ra, 5.5 m lead, cl. I, mid-post mount
 See lumen packages in the Nyx specs at focus-lighting.dk



Mid-column housing	Price
empty = post top	0
G = mid-column moun	101

In case of mid-column mounting, please add the letter G to the order code.

OPTIONAL COMPONENTS



Special shade for Nyx 330			
Product code	Description	Net price excl. VAT	EUR
06034	Lamella shade		54
1712-1	Adapter for 48 and 42 mm post top		27



Double arm for Nyx 330			
Product code	Description	Net price excl. VAT	EUR
8001-	Double arm, 2 x 400 mm, galvanised		336
8002-	Double arm, 2 x 800 mm, galvanised		349

Select colour in the table below.

Colour	Price
3 = black RAL 9005	81
4 = graphite grey	81
7 = galvanised	0
9 = silver grey	81
17 = corten brown	81
66 = black noir 900	81
Other RAL colours	81

Example Order code: 8001-9 = 2x400 mm double arm for Nyx 330, silver grey

NYX 450

The luminaire is supplied with 9.5 m lead, 2 x 1 mm², + 2 meter in case of side entry



Ø 450 mm, FF-DA board with T3 lenses for local roads, P, HS, and C classes			
Product code	Definition	Net price excl. VAT	EUR
9930-	LED 2xFF-DA, T3, programmable, 9.5 m lead		916
9931-	LED 3xFF-DA, T3, programmable, 9.5 m lead		999
9932-	LED 4xFF-DA, T3, programmable, 9.5 m lead		1082

Ø 450 mm, FF-DA board with MEW lenses for traffic roads, M classes			
Product code	Definition	Net price excl. VAT	EUR
9950-	LED 2xFF-DA, MEW, programmable, 9.5 m lead		916
9951-	LED 3xFF-DA, MEW, programmable, 9.5 m lead		999
9952-	LED 4xFF-DA, MEW, programmable, 9.5 m lead		1082

Ø 450 mm, FF-DA board with T4 lenses for roundabouts and wide roads			
Product code	Definition	Net price excl. VAT	EUR
9940-	LED 2xFF-DA, T4, programmable, 9.5 m lead		916
9941-	LED 3xFF-DA, T4, programmable, 9.5 m lead		999
9942-	LED 4xFF-DA, T4, programmable, 9.5 m lead		1082

Ø 450 mm, FF-DA board with PX lenses for pedestrian crossings			
Product code	Definition	Net price excl. VAT	EUR
9955-	LED 2xFF-DA, PX, programmable, 9.5 m lead		916
9956-	LED 3xFF-DA, PX, programmable, 9.5 m lead		999

Select colour, colour temperature, and mounting in the table below and construct the order code as shown below.							
Colour	Price	Colour temperature	Price	Mounting	Price	Control/Dimming	Price
01 = raw anodized	0	730 = 3000 K, 70 Ra	0	T = post top	0	empty = programmed	0
4 = graphite grey	0	740 = 4000 K, 70 Ra	0	U = side entry Ø60	0	D = DALI-2	0
9 = silver grey	0	827* = 2700 K, 80 Ra	0	U48 = side entry Ø48	40	F = LineSwitch	0
66 = noir 900	0	830* = 3000 K, 80 Ra	0	G = mid-post housing	148	R = Zhaga socket up, D4i	67
Other RAL colours	67	840* = 4000 K, 80 Ra	0	G76 = mid-post Ø76	148	RC = CityTch/InteractCity, D4i	67
		* Longer lead times				S = Zhaga socket down, D4i	67
Protection class	Price					RS = Zhaga sockets up/down, □	94
empty = class II	0						
J = class I	0					N = Halogen-free cables	13
Corrosion coating			Price			X = Varistor 10 kV	54
C5 = C5 coating			81				
Add C5 after the colour code. Example: 9930-9C5730							

Example Order code: 9951-9740TJ = Nyx 450 3xFF, MEW, silver grey, 4000K 70 Ra, post top mounting, class I
See lumen packages in the Nyx specs at focus-lighting.dk

OPTIONAL COMPONENTS

Product code	Description	Net price excl. VAT	EUR
9023-	Wall bracket		161
Colour	Price		
4 = graphite grey	0		
9 = silver grey	0		
66 = noir 900	0		

TURN

8.5 m lead included



Turn Spot				
Product code	Beam angle	Definition	Net price excl. VAT	EUR
8836-	Wide 38°	Bridgelux V18, programmable		839
8837-	Medium 19°	Bridgelux V18, programmable		839
8838-	Narrow 12°	Bridgelux V18, programmable		839

Turn Spot Halo				
Product code	Beam angle	Definition	Net price excl. VAT	EUR
8840-	Wide 38°	Bridgelux V18, programmable		839
8841-	Medium 19°	Bridgelux V18, programmable		839
8842-	Narrow 12°	Bridgelux V18, programmable		839

Select colour, colour temperature, lead length etc. in the table below and construct the order code as shown below.

Colour	Price	Colour temperature	Price	Control/Dimming	Price	Protection class	Price
01 = raw anodized	0	827 = 2700 K, 80 Ra	0	empty = programmed	0	empty = class II	0
4 = graphite grey	0	830 = 3000 K, 80 Ra	0	D = DALI-2	0	J = class I	0
9 = silver grey	0	840 = 4000 K, 80 Ra	0	F = LineSwitch	0		
17 = corten brown	0			R = Zhaga socket up, D4i	134		
66 = noir 900	0			RC = CityTch/InteractCity, D4i	134		
Other RAL colours	67						

Filter	Price	Mounting brackets	Price
empty = no filter	0	empty = bracket for cylindrical pole, Ø76 mm	0
Y = honeycomb filter	20	B90 = brackets for conical pole, Ø60-90 mm	134
		B121 = brackets for conical pole, Ø91-121 mm	134
		Adapter for Ø60 mm rod, see options under Poles	

Corrosion coating	Price
C5 = C5 coating	81

Add C5 after the colour code. Example: 8836-9C5730

Example Order code: 8836-4840DJ = Turn Spot, wide, graphite grey, 4000 K, 80 Ra, Dali, class I, for cylindrical pole

Turn Street Halo			
Product code	Definition	Net price excl. VAT	EUR
8920-	LED 1xDA 2x4, T3 lenses, programmable		839

Select colour, colour temperature, lead length etc. in the table below and construct the order code as shown below.

Colour	Price	Colour temperature	Price	Control/Dimming	Price	Protection class	Price
01 = raw anodized	0	827 = 2700 K, 80 Ra	0	empty = programmed	0	empty = class II	0
4 = graphite grey	0	830 = 3000 K, 80 Ra	0	D = DALI-2	0	J = class I	0
9 = silver grey	0	840 = 4000 K, 80 Ra	0	F = LineSwitch	0		
17 = corten brown	0			R = Zhaga socket up, D4i	134		
66 = noir 900	0			RC = CityTch/InteractCity, D4i	134		
Other RAL colours	67						

Mounting brackets	Price
empty = bracket for cylindrical pole, Ø76 mm	0
B90 = brackets for conical pole, Ø60-90 mm	134
B121 = brackets for conical pole, Ø91-121 mm	134
Adapter for Ø60 mm rod, see options under Poles	

Corrosion coating	Price
C5 = C5 coating	81

Add C5 after the colour code. Example: 8920-9C5730

Example Order code: 8920-66730J = Turn Street Halo, black noir 900, 3000 K, 70 Ra, class I, for cylindrical pole

Turn Gobo			
Product code	Definition	Net price excl. VAT	EUR





8846-	LED 40 W, 85 mm lens "standard"	3280			
8848-	LED 40 W, 63 mm lens "wide"	3280			
Select colour, control, etc. in the table below and add the code to the item number.					
Colour	Price	Control	Price	Mounting brackets	Price
01 = raw anodized	0	D = DALI-2	108	empty = bracket for cylindrical pole, Ø76 mm	0
4 = graphite grey	0			B90 = brackets for conical pole, Ø60-90 mm	134
9 = silver grey	0	Protection class	Price	B121 = brackets for conical pole, Ø91-121 mm	134
17 = corten brown	0	empty = class II	0	Adapter for Ø60 mm rod, see options under Poles	
66 = noir 900	0	J = class I	0		
Other RAL colours	67				
Corrosion coating			Price		
C5 = C5 coating			81		
Add C5 after the colour code. Example: 8920-9C5730					

Example Order code: 8846-66J = Turn Gobo, black noir 900, class I

Gobo glass 50 mm + colour filters			
Product code	Definition	Net price excl. VAT	EUR
8846-008	Gobo glass, black/white		53
8846-0081	Gobo glass, black + colour filter or colour correction filter (3000 or 4000 K) (whole glass)		71
8846-0082	Gobo glass, 1 colour filter (adjusted to graphics)		108
8846-0083	Gobo glass, 2 colour filters		175
8846-0084	Gobo glass, 3 colour filters		220
8846-0085	Gobo glass, multicolour 4c		264
8846-0086	Gobo glass, grey scale		71

We grant no discount on Gobo glass and filters.



Turn bracket for wall mounting			
Product code		Net price excl. VAT	EUR
8011-	Bracket for 1 spot. Spot and bracket will be assembled by Focus Lighting.		479
8012-	Bracket for 2 spots. Spots and bracket will be assembled by Focus Lighting.		509
Select colour in the table below.			
Colour	Price		
01 = raw anodized	0		
4 = graphite grey	0		
9 = silver grey	0		
17 = corten brown	0		
66 = black noir 900	0		
Other RAL colours	54		

SPACE



Ø 640 mm, symmetrical			
Product code	Definition	Net price excl. VAT	EUR
8880-	Bridgelux V18 Low lumen, programmable, 5.5 m lead included		947
8882-	Bridgelux V22 High lumen, programmable, 5.5 m lead included		947

Ø 640 mm, asymmetrical type IV			
Product code	Definition	Net price excl. VAT	EUR
8901-	Bridgelux V18 Low lumen, programmable, 5.5 m lead included		947
8902-	Bridgelux V22 High lumen, programmable, 5.5 m lead included		947

Ø 640 mm, asymmetrical type II			
Product code	Definition	Net price excl. VAT	EUR
8884-	Bridgelux V18 Low lumen, programmable, 5.5 m lead included		947
8885-	Bridgelux V22 High lumen, programmable, 5.5 m lead included		947

Select colour and colour temperature in the table below and construct the order code as shown below.							
Colour	Price	Colour temperature	Price	Mounting	Price	Control/Dimming	Price
01 = raw anodized	0	827 = 2700 K, 80 Ra	0	empty = Ø60 mm pole	0	empty = programmed	0
4 = graphite grey	0	830 = 3000 K, 80 Ra	0	M76 = Ø76 mm pole	47	D = DALI-2	0
9 = silver grey	0	840 = 4000 K, 80 Ra	0			F = LineSwitch	0
17 = corten brown	0	930* = 3000 K, 90 Ra	0			R = Zhaga socket up, D4i	67
66 = noir 900	0	* Longer lead times				RC = CityTch/InteractCity, D4i	67
Other RAL colours	80					S = Zhaga socket down, D4i	67
Protection class	Price					RS = Zhaga sockets up/down, D	94
empty = class II	0						
J = class I	0					N = Halogen-free cables	13
Corrosion coating					Price	X = Varistor 10 kV	54
C5 = C5 coating					81		

Add C5 after the colour code. Example: 8880-9C5827

Example Order code: 8882-66830M76J = Space symmetric, max 6400 lm, black noir 900, 3000K 80Ra, Ø76 pole, cl. I
 See lumen packages in the Space specs at focus-lighting.dk



Accessories		Net price excl. VAT	EUR
8016-	Connection ring for 80/90 mm column diameter		13
8017-	Shade in coated aluminium - combine with the colour codes above.		201

SKY PARK



Ø 480 mm, LED, programmable driver			
Product code	Definition	Net price excl. VAT	EUR
8833-	Bridgelux V18 Low lumen, programmable, 4 m lead included		839
8930-	Bridgelux V22 High lumen, programmable, 4 m lead included		839

Select colour and colour temperature in the table below and construct the order code as shown below.

Colour	Price	Colour temperature	Price	Mounting	Price	Control/Dimming	Price
01 = raw anodized	0	827 = 2700 K, 80 Ra	0	empty = Ø60 mm pole	0	empty = programmed	0
4 = graphite grey	0	830 = 3000 K, 80 Ra	0	M76 = Ø76 mm pole	47	D = DALI-2	0
9 = silver grey	0	840 = 4000 K, 80 Ra	0			F = LineSwitch	0
17 = corten brown	0	930* = 3000 K, 90 Ra	0			R = Zhaga socket up, D4i	134
66 = noir 900	0	* Longer lead times				RC = CityTch/InteractCity, D4i	134
Other RAL colours	80						
Protection class	Price					N= Halogen-free cables	13
empty = class II	0					X = Varistor 10 kV	54
J = class I	0						
Corrosion coating			Price				
C5 = C5 coating			81				

Add C5 after the colour code. Example: 8833-9C5827

Example Order code: 8833-9830J = Sky Park, max 3800 lm, silver grey, 3000 K 80 Ra, f. Ø60 mm pole, class I

See lumen packages in the Sky specs at focus-lighting.dk



Accessories		Net price excl. VAT	EUR
8006-	Shade in coated aluminium - combine with the colour codes above.		60
8005-	Connection ring for 90 mm column		13

SKY WALL



Ø 480 mm, LED, programmable driver			
Product code	Definition	Net price excl. VAT	EUR
6834-	Bridgelux V18 Low lumen, programmable		1190
6836-	Bridgelux V22 High lumen, programmable		1190

Select colour and colour temperature in the table below and construct the order code as shown below.

Colour	Price	Colour temperature	Price	Dimming	Price	Protection class	Price
01 = raw anodized	0	827 = 2700 K, 80 Ra	0	empty = programmed	0	empty = class II	0
4 = graphite grey	0	830 = 3000 K, 80 Ra	0	D = DALI-2	0	J = class I	0
9 = silver grey	0	840 = 4000 K, 80 Ra	0	F = LineSwitch	0		
17 = corten brown	0	930* = 3000 K, 90 Ra	0				
66 = noir 900	0	* Longer lead times					
Other RAL colours	80						
Corrosion coating			Price				
C5 = C5 coating			81				

Add C5 after the colour code. Example: 6834-9C5827

Example Order code: 6834-9827J = Sky Wall, Low lumen, silver grey, 2700 K 80 Ra, class I

See lumen packages in the Sky specs at focus-lighting.dk

SKY BOLLARD



H 1020 mm, LED, galvanised				
Product code	Mounting	Definition	Net price excl. VAT	EUR
7852-	rooted base w. cross bars	6 W Bridgelux V8, 250 mA		870
7851-	rooted base for concrete	6 W Bridgelux V8, 250 mA		870
7853-	flanged base	6 W Bridgelux V8, 250 mA		916
7830-	rooted base w. cross bars	9 W Bridgelux V8, 350 mA		870
7833-	rooted base for concrete	9 W Bridgelux V8, 350 mA		870
7836-	flanged base	9 W Bridgelux V8, 350 mA		916
7831-	rooted base w. cross bars	12 W Bridgelux V8, 500 mA		870
7839-	rooted base for concrete	12 W Bridgelux V8, 500 mA		870
7837-	flanged base	12 W Bridgelux V8, 500 mA		916

Select colour and colour temperature in the table below and construct the order code as shown below.							
Colour	Price	Colour temperature	Price	Dimming	Price	Protection class	Price
4 = graphite grey	107	927 = 2700 K, 90 Ra	0	V = 1-10 V	10	empty = class II	0
9 = silver grey	107	930 = 3000 K, 90 Ra	0	D = DALI	20	J = class I	0
7 = silver/galvanised	0	940 = 4000 K, 90 Ra	0	E = programmable	27		
17 = corten brown	107			DE = progr. + DALI-2	40	Surge protection	
66 = noir 900	107					X = 10 kV	54
Other RAL colours	107						

Example Order code: 7831-4930J = Sky Bollard rooted base, 12 W LED, graphite grey, 3000 K, 90 Ra, class I

STICKS



Sticks 900, LED, single light slit				
Product code	Mounting	Definition	Net price excl. VAT	EUR
7840-	rooted base	8 W, 500 mA		947
7846-	flanged base	8 W, 500 mA		992
7843-	rooted base	11 W, 700 mA		947
7848-	flanged base	11 W, 700 mA		992

Sticks 900, LED, double light slit				
Product code	Mounting	Definition	Net price excl. VAT	EUR
7841-	rooted base	15 W, 500 mA		1053
7847-	flanged base	15 W, 500 mA		1082
7850-	rooted base	20 W, 700 mA		1053
7849-	flanged base	20 W, 700 mA		1082

Select colour and colour temperature in the table below and construct the order code as shown below.

Colour	Price	Colour temperature	Price	Dimming	Price	Protection class	Price
01 = raw anodized	0	827 = 2700 K, 80 Ra	0	empty = no dimming	0	empty = class II	0
3 = black	0	830 = 3000 K, 80 Ra	0	V = 1-10 V	10	J = class I	0
4 = graphite grey	0			D = DALI	20		
9 = silver grey	0						
17 = corten brown	0						
66 = noir 900	0						
Other RAL colours	108						

Example Order code: 7840-66830 = Sticks 900 single light slit, LED, rooted base, noir 900, 3000 K



Sticks 3000, LED, single light slit				
Product code	Mounting	Definition	Net price excl. VAT	EUR
8834-	rooted base	14 W T8-900 mm LED tube		1816
8844-	flanged base	14 W T8-900 mm LED tube		1860

Sticks 3000, LED, double light slit				
Product code	Mounting	Definition	Net price excl. VAT	EUR
8835-	rooted base	2 x 14 W T8-900 mm LED tube		1847
8845-	flanged base	2 x 14 W T8-900 mm LED tube		1891

Select colour and colour temperature in the table below and construct the order code as shown below.

Colour	Price	Colour temperature	Price	Protection class	Price		
3 = black	0	730 = 3000 K, 70 Ra	0	empty = class II	0		
4 = graphite grey	0						
9 = silver grey	0						
17 = corten brown	0						
66 = noir 900	0						
Other RAL colours	269						

Example Order code: 8834-66730 = Sticks 3000 single light slit, LED, rooted base, noir 900, 3000 K

DUA



Dua Bollard, H 1000 mm				
Product code	Mounting	Definition	Net price excl. VAT	EUR
7980-	rooted base w. cross bars	9 W Bridgelux V8/V6, 250 mA		1142
7982-	rooted base for concrete	9 W Bridgelux V8/V6, 250 mA		1142
7981-	flanged base	9 W Bridgelux V8/V6, 250 mA		1142
7855-	rooted base w. cross bars	12 W Bridgelux V8/V6, 350 mA		1142
7857-	rooted base for concrete	12 W Bridgelux V8/V6, 350 mA		1142
7858-	flanged base	12 W Bridgelux V8/V6, 350 mA		1142

Select colour and colour temperature in the table below and construct the order code as shown below.

Colour	Price	Colour temperature	Price	Dimming	Price	Protection class	Price
01 = raw anodized	0	927 = 2700 K, 90 Ra	0	V = 1-10 V	10	empty = class II	0
4 = graphite grey	0	930 = 3000 K, 90 Ra	0	D = DALI-2	20	J = class I	0
9 = silver grey	0	940 = 4000 K, 90 Ra	0	E = programmable	47		
17 = corten brown	0			DE = progr. + DALI-2	60	Surge protection	
66 = noir 900	0					X = 10 kV	54
Other RAL colours	80						

Example Order code: 7855-66930J = Dua Bollard rooted base, 12 W LED, black noir 900, 3000 K, 90 Ra, class I



Dua Bollard Low, H 570 mm				
Product code	Mounting	Definition	Net price excl. VAT	EUR
7983-	rooted base w. cross bars	6 W Bridgelux V8, 250 mA		889
7985-	rooted base for concrete	6 W Bridgelux V8, 250 mA		889
7984-	flanged base	6 W Bridgelux V8, 250 mA		889
7856-	rooted base w. cross bars	9 W Bridgelux V8, 350 mA		889
7854-	rooted base for concrete	9 W Bridgelux V8, 350 mA		889
7859-	flanged base	9 W Bridgelux V8, 350 mA		889

Select colour and colour temperature in the table below and construct the order code as shown below.

Colour	Price	Colour temperature	Price	Dimming	Price	Protection class	Price
01 = raw anodized	0	927 = 2700 K, 90 Ra	0	V = 1-10 V	10	empty = class II	0
4 = graphite grey	0	930 = 3000 K, 90 Ra	0	D = Dali-2	20	J = class I	0
9 = silver grey	0	940 = 4000 K, 90 Ra	0				
17 = corten brown	0						
66 = noir 900	0						
Other RAL colours	67						

Example Order code: 7856-4930J = Dua Bollard Low rooted base, 9 W LED, graphite grey, 3000 K, 90 Ra, class I



Dua High, H 3000 mm, single-sided				
Product code	Mounting	Definition	Net price excl. VAT	EUR
8940-	rooted base	13 W Bridgelux V18, 350 mA		1812
8941-	flanged base	13 W Bridgelux V18, 350 mA		1812
8946-	rooted base	19 W Bridgelux V18, 500 mA		1812
8947-	flanged base	19 W Bridgelux V18, 500 mA		1812

Dua High, H 3000 mm, double-sided				
Product code	Mounting	Definition	Net price excl. VAT	EUR
8942-	rooted base	13 W Bridgelux V18, 350 mA		1812
8943-	flanged base	13 W Bridgelux V18, 350 mA		1812
8948-	rooted base	19 W Bridgelux V18, 500 mA		1812
8949-	flanged base	19 W Bridgelux V18, 500 mA		1812

Select colour and colour temperature in the table below and construct the order code as shown below.							
Colour	Price	Colour temperature	Price	Dimming	Price	Protection class	Price
01 = raw anodized	0	927 = 2700 K, 90 Ra	0	D = DALI-2	20	empty = class II	0
4 = graphite grey	0	930 = 3000 K, 90 Ra	0	E = programmable	47	J = class I	0
9 = silver grey	0	940 = 4000 K, 90 Ra	0				
17 = corten brown	0					Surge protection	
66 = noir 900	0					X = 10 kV	54
Other RAL colours	134						

Example Order code: 8942-66830 = Dua High double, rooted base, noir 900, 3000 K, 80 Ra

TEMA BOLLARD



H 1000 mm, LED				
Product code	Mounting	Definition	Net price excl. VAT	EUR
7886-	rooted base w. cross bars	8 W Bridgelux Vero 10, 250 mA		810
7860-	rooted base for concrete	8 W Bridgelux Vero 10, 250 mA		810
7871-	flanged base	8 W Bridgelux Vero 10, 250 mA		839
7887-	rooted base w. cross bars	12 W Bridgelux Vero 10, 350 mA		810
7862-	rooted base for concrete	12 W Bridgelux Vero 10, 350 mA		810
7872-	flanged base	12 W Bridgelux Vero 10, 350 mA		839
7888-	rooted base w. cross bars	16 W Bridgelux Vero 10, 500 mA		810
7863-	rooted base for concrete	16 W Bridgelux Vero 10, 500 mA		810
7873-	flanged base	16 W Bridgelux Vero 10, 500 mA		839

Select colour and colour temperature in the table below and construct the order code as shown below.							
Colour	Price	Colour temperature	Price	Dimming	Price	Protection class	Price
9 = galvanised	0	927 = 2700 K, 90 Ra	0	V = 1-10 V	10	empty = class I	0
RAL colours	121	930 = 3000 K, 90 Ra	0	D = DALI	20	K = class II	155
		940 = 4000 K, 90 Ra	0	E = programmable	27		
				DE = progr. + DALI-2	40		

Example order code: 7887-9930 = Tema Bollard, rooted base, galvanised, 12 W LED, 3000 K, 90 Ra, class I

H 1000 mm, E27				
Product code	Mounting	Definition	Net price excl. VAT	EUR
7061-	rooted base w. cross bars	max 52 W E27, max L/Ø: 140/56 mm		719
7062-	rooted base for concrete	max 52 W E27, max L/Ø: 140/56 mm		719
7064-	flanged base	max 52 W E27, max L/Ø: 140/56 mm		748

Select colour in the table below and construct the order code as shown below.				
Colour	Price	Protection class	Price	
9 = galvanised	0	empty = class I	0	
RAL colours	121	K = class II	155	

Example order code: 7061-9 = Tema Bollard, rooted base, galvanised, E27, class I

Extra			
Product code	Type	Net price excl. VAT	EUR
70620	Preparation for socket outlet		107

PHAROS



H 850 mm, E27			
Product code	Definition	Net price excl. VAT	EUR
7009-	E27, max 77 W, max length 170 mm, max diameter 48 mm		1128

Select finish in the table below.			
Finish/material	Price		
8 = copper	On request		
9 = galvanised	0		
Example Order code: 7009-9 = Pharos galvanised, E27			

Extras			
Product code	Type	Net price excl. VAT	EUR
70193	Rooted base		175
70194	Base for concrete		175

NYX 190



Ø 190 mm, LED, for bollard mounting		
Product code	Definition	Net price excl. VAT EUR
6889-	6 W Bridgelux V6, 250 mA	302
6841-	8 W Bridgelux V6, 350 mA	302
6842-	11 W Bridgelux V6, 500 mA	302
6888-	16 W Bridgelux V6, 700 mA	302

Select colour, colour temperature, etc. in the table below and construct the order code as shown below.

Colour	Price	Colour temperature	Price	Dimming	Price	Protection class	Price
01 = raw anodized	0	927 = 2700 K, 90 Ra	0	empty = no dimming	0	empty = class I	0
3 = black	0	930 = 3000 K, 90 Ra	0	V = 1-10 V	10	K = class II	13
4 = graphite grey	0	940 = 4000 K, 90 Ra		D = DALI	20		
9 = silver grey	0			E = programmable	27		
17 = corten brown	0						
66 = noir 900	0						
Other RAL colours	40						
Corrosion coating			Price				
C5 = C5 coating			81				

Add C5 after the colour code. Example: 6841-9C5927

Example Order code: 6841-66930 = Nyx 190, 8 W LED for bollard, noir 900, 3000K 90 Ra, class I

NYX BOLLARD

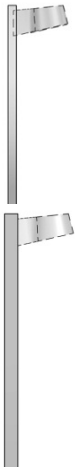

Nyx Bollard 1000		
Product code	Aluminium, height: 1000 mm	Net price excl. VAT EUR
7021-	rooted base	321
7022-	flanged base	367

Nyx Bollard 1200 with door for fuse box		
Product code	Aluminium, height: 1200 mm	Net price excl. VAT EUR
7023-	rooted base	549
7024-	flanged base	596

Select colour in the table below and construct the order code as shown below.

Colour	Price	Protection class	Price	Class II in bollards with fuse box only.
01 = raw anodized	0	empty = class I	0	
3 = black	0	K = class II	0	
4 = graphite grey	0			
9 = silver grey	0			
17 = corten brown	0			
66 = noir 900	0			
Other RAL colours	121			
Corrosion coating			Price	
C5 = C5 coating			81	

Add C5 after the colour code. Example: 7023-9C5

Example Order code: 7023-9K = Nyx Bollard 1200 for embedment, silver grey, class II

The prices quoted are without fitting. Please order Nyx 190 separately.



Ø 190 mm, LED, for wall mounting		
Product code	Definition	Net price excl. VAT EUR

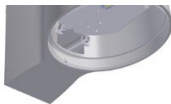

6877-	6 W Bridgelux V8, 250 mA	214
6843-	8 W Bridgelux V8, 350 mA	214
6844-	11 W Bridgelux V8, 500 mA	214

Select colour, colour temperature, etc. in the table below and construct the order code as shown below.

Colour	Price	Colour temperature	Price	Dimming	Price	Protection class	Price
01 = raw anodized	0	927 = 2700 K, 90 Ra	0	empty = no dimming	0	empty = class I	0
3 = black	0	930 = 3000 K, 90 Ra	0	V = 1-10 V	10	K = class II	13
4 = graphite grey	0	940 = 4000 K, 90 Ra	0	D = DALI	20		
9 = silver grey	0			E = programmable	27		
17 = corten brown	0						
66 = noir 900	0						
Other RAL colours	40						
Corrosion coating			Price				
C5 = C5 coating			81				

Add C5 after the colour code. Example: 6877-9C5927

Example Order code: 6843-4930D = Nyx 190 12 W LED, graphite grey, 3000K 90 Ra, Dali, class I



Ø 190 mm, E27 version		
Product code	Definition	Net price excl. VAT EUR
6022-	max 57 W, max length 130 mm, max diameter 58 mm	199
1100-2	Philips Core Pro LED, 9 W, 2700 K, 80 Ra, 15,000 service hours	6
1100-3	Philips Core Pro LED, 9 W, 3000 K, 80 Ra, 15,000 service hours	6
1100-8	Philips Core Pro LED, 11 W, 2700 K, 80 Ra, 15,000 service hours	6
1100-7	Philips Core Pro LED, 13 W, 3000 K, 80 Ra, 15,000 service hours	6
We grant no discount on the lamps.		

Colour	Price	Protection class	Price
01 = raw anodized	0	empty = class I	0
3 = black	0	K = class II	13
4 = graphite grey	0		
9 = silver grey	0		
17 = corten brown	0		
66 = noir 900	0		
Other RAL colours	40		
Corrosion coating		Price	
C5 = C5 coating		81	

Add C5 after the colour code. Example: 6022-9C5

Example Order code: 6022-9 = Nyx 190 E27, silver grey, class I

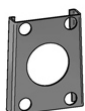

Base for visible cables		
Product code		Net price excl. VAT EUR
1711-	Base for cable entry on wall	27
Colour	Price	
3 = black	0	
4 = graphite grey	0	
9 = silver grey	0	
17 = corten brown	0	
66 = noir 900	0	

NYX 330 WALL



Ø 330 mm, LED Comfort with programmable driver			
Product code	Definition	Net price excl. VAT	EUR
6990-	LED Comfort, programmable		657

Select colour, colour temperature, etc. in the table below and construct the order code as shown below.

Colour	Price	Colour temperature	Price	Screen type	Price	Dimming	Price
01 = raw anodized	0	827 = 2700 K, 80 Ra	0	empty = frosted screen	0	empty = programme	0
3 = black	0	830 = 3000 K, 80 Ra	0	O = opal screen	0	D = DALI-2	0
4 = graphite grey	0	840 = 4000 K, 80 Ra	0			F = LineSwitch	0
9 = silver grey	0						
17 = corten brown	0						
66 = noir 900	0						
Other RAL colours	67						

Protection class	Price
empty = class I	0
K = class II	13

Corrosion coating	Price
C5 = C5 coating	81

Add C5 after the colour code. Example: 6990-9C5827

Example Order code: 6990-9830 = Nyx 330 Comfort, silver grey, 3000K 80 Ra, class I

See lumen packages in the Nyx specs at focus-lighting.dk

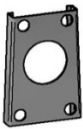

Base for visible cables		
Product code	Net price excl. VAT	EUR
1721-	Base for cable entry on wall	27

Add one of the colour codes below to the product code.

Colour	Price
3 = black	0
4 = graphite grey	0
9 = silver grey	0
17 = corten brown	0
66 = noir 900	0

QUARTO INTERIOR



270 mm, LED			
Product code	Definition	Net price excl. VAT	EUR
4802-	6 W Bridgelux V8, 250 mA		191
4803-	8 W Bridgelux V8, 350 mA		191
4804-	11 W Bridgelux V8, 500 mA		191

Select colour, colour temperature, etc. in the table below and construct the order code as shown below.

Colour	Price	Colour temperature	Price	Dimming	Price	Protection class	Price
1 = white	0	927 = 2700 K, 90 Ra	0	V = 1-10 V	10	empty = class I	0
3 = black	0	930 = 3000 K, 90 Ra	0	D = DALI	20	K = class II	13
4 = graphite grey	0	940 = 4000 K, 90 Ra	0	S = switch	20		
5 = polished nickel	94			R = bluetooth sensor	81		
6 = polished brass	120						
8 = polished copper	120						
Other RAL colours	40						

Example Order code: 4803-8927V = Quarto 270 interior, copper, 9 W LED, 2700 K, 90 Ra, 1-10 V dimming, cl I

270 mm, E27 LED			
Product code	Definition	Net price excl. VAT	EUR
4001-	max 57 W, max length 110 mm, max diameter 56 mm		120
1100-2	Philips Core Pro LED, 9 W, 2700 K, 80 Ra, 15,000 service hours		6
1100-3	Philips Core Pro LED, 9 W, 3000 K, 80 Ra, 15,000 service hours		6
1100-8	Philips Core Pro LED, 11 W, 2700 K, 80 Ra, 15,000 service hours		6
1100-7	Philips Core Pro LED, 13 W, 3000 K, 80 Ra, 15,000 service hours		6
1100-4	Philips Core Pro LED, 15 W, 2700 K, 80 Ra, 15,000 service hours		6
1100-6	A60 Deco Aurora LED dimmable, 7.5 W, 2700 K, 80 Ra, 20,000 service hours		11
We grant no discount on the lamps.			

Select colour in the table below and construct the order code as shown below.

Colour	Price
1 = white	0
3 = black	0
4 = graphite grey	0
5 = polished nickel	94
6 = polished brass	120
8 = polished copper	120
Other RAL colours	40

Example Order code: 4001-3 = Quarto 270 interior, black, E27

QUARTO EXTERIOR



270 mm, LED			
Product code	Definition	Net price excl. VAT	EUR
6807-	6 W Bridgelux V8, 250 mA		222
6803-	8 W Bridgelux V8, 350 mA		222
6804-	11 W Bridgelux V8, 500 mA		222

Select colour, colour temperature, etc. in the table below and construct the order code as shown below.

Colour	Price	Colour temperature	Price	Dimming	Price	Protection class	Price
1 = white	20	927 = 2700 K, 90 Ra	0	V = 1-10 V	10	empty = class I	0
3 = black	20	930 = 3000 K, 90 Ra	0	D = DALI	20	K = class II	13
4 = graphite grey	20	940 = 4000 K, 90 Ra	0	R = bluetooth sensor	81		
6 = polished brass	121						
8 = polished copper	121						
9 = galvanised	0						
17 = corten brown	20						
66 = noir 900	20						
Other RAL colours	40						

Example Order code: 6804-8930 = Quarto 270 exterior, copper, 12 W LED, 3000 K, 90 Ra, class I

270 mm, E27 LED			
Product code	Definition	Net price excl. VAT	EUR
6001-	max 57 W, max length 110 mm, max diameter 56 mm		160
1100-2	Philips Core Pro LED, 9 W, 2700 K, 80 Ra, 15,000 service hours		6
1100-3	Philips Core Pro LED, 9 W, 3000 K, 80 Ra, 15,000 service hours		6
1100-8	Philips Core Pro LED, 11 W, 2700 K, 80 Ra, 15,000 service hours		6
1100-7	Philips Core Pro LED, 13 W, 3000 K, 80 Ra, 15,000 service hours		6
1100-4	Philips Core Pro LED, 15 W, 2700 K, 80 Ra, 15,000 service hours		6
1100-6	A60 Deco Aurora LED dimmable, 7.5 W, 2700 K, 80 Ra, 20,000 service hours		11
We grant no discount on the lamps.			

Select colour in the table above and construct the order code as shown below.

Example Order code: 6001-3 = Quarto 270 exterior, black RAL 9005, E27, class I

BOLLARD Q



H 850 mm - single-sided (for Quarto 270)			
Product code	Mounting	Net price excl. VAT	EUR
7006-	rooted base		427
7007-	flanged base		489

Select colour in the table below and construct the order code as shown below.

Colour	Price
8 = copper	On request
9 = galvanised	0
Other RAL colours	120

Example Order code: 7006-9 = Bollard Q for embedment, galvanised

QUARTO 380



380 mm, LED			
Product code	Definition	Net price excl. VAT	EUR
6808-	9 W Bridgelux V8, 350 mA		398
6809-	12 W Bridgelux V8, 500 mA		398
6810-	17 W Bridgelux V8, 700 mA		398

Select colour, colour temperature, etc. in the table below and construct the order code as shown below.

Colour	Price	Colour temperature	Price	Dimming	Price	Protection class	Price
1 = white	26	927 = 2700 K, 90 Ra	0	V = 1-10 V	10	empty = class I	0
3 = black	26	930 = 3000 K, 90 Ra	0	D = DALI	20	K = class II	13
4 = graphite grey	26	940 = 4000 K, 90 Ra	0	R = bluetooth sensor	81		
6 = polished brass	147						
8 = polished copper	147						
9 = galvanised	0						
17 = corten brown	26						
66 = noir 900	26						
Other RAL colours	40						

Example Order code: 6810-9930 = Quarto 380, galvanised, 17 W LED, 3000 K, 90 Ra, class I

380 mm, E27 versions			
Product code	Definition	Net price excl. VAT	EUR
6004-	max 116 W, max length 145 mm		352
1100-2	Philips Core Pro LED, 9 W, 2700 K, 80 Ra, 15,000 service hours		6
1100-3	Philips Core Pro LED, 9 W, 3000 K, 80 Ra, 15,000 service hours		6
1100-8	Philips Core Pro LED, 11 W, 2700 K, 80 Ra, 15,000 service hours		6
1100-7	Philips Core Pro LED, 13 W, 3000 K, 80 Ra, 15,000 service hours		6
1100-4	Philips Core Pro LED, 15 W, 2700 K, 80 Ra, 15,000 service hours		6
1100-6	A60 Deco Aurora LED dimmable, 7.5 W, 2700 K, 80 Ra, 20,000 service hours		11
We grant no discount on the lamps.			

Select colour in the table below and construct the order code as shown below.

Farbe	Preis
1 = white	26
3 = black	26
4 = graphite grey	26
6 = polished brass	147
8 = polished copper	147
9 = galvanised	0
17 = corten brown	26
66 = noir 900	26
Other RAL colours	40

Example Order code: 6004-66 = Quarto 380, noir 900, E27, class I

SQUARE 250 INTERIOR



250 mm, LED			
Product code	Definition	Net price excl. VAT	EUR
4823-	10 W Bridgelux, 250 mA		297
4820-	15 W Bridgelux, 350 mA		297
4822-	8 W Bridgelux, 250 mA, downwards only		297
4821-	12 W Bridgelux, 350 mA, downwards only		297

Select colour, colour temperature, etc. in the table below and construct the order code as shown below.							
Colour	Price	Colour temperature	Price	Dimming	Price	Protection class	Price
1 = white	0	927 = 2700 K, 90 Ra	0	V = 1-10 V	10	empty = class I	0
3 = black	0	930 = 3000 K, 90 Ra	0	D = DALI	20	K = class II	13
4 = graphite grey	0	940 = 4000 K, 90 Ra	0	S = switch	20		
Other RAL colours	41			R = bluetooth sensor	81		

Example Product code: 4820-3927V = Square 250 interior, black, 15 W LED, 2700 K, 90 Ra, 1-10 V dimming

250 mm, E27 LED			
Product code	Definition	Net price excl. VAT	EUR
4009-	max 30 W, E27		183
4012-	max 30 W, E27, downwards only		183
1100-2	Philips Core Pro LED, 9 W, 2700 K, 80 Ra, 15,000 service hours		6
1100-3	Philips Core Pro LED, 9 W, 3000 K, 80 Ra, 15,000 service hours		6
1100-8	Philips Core Pro LED, 11 W, 2700 K, 80 Ra, 15,000 service hours		6
1100-7	Philips Core Pro LED, 13 W, 3000 K, 80 Ra, 15,000 service hours		6
1100-4	Philips Core Pro LED, 15 W, 2700 K, 80 Ra, 15,000 service hours		6
1100-6	A60 Deco Aurora LED dimmable, 7.5 W, 2700 K, 80 Ra, 20,000 service hours		11
We grant no discount on the lamps.			

Select colour in the table below and construct the order code as shown below.		
Colour	Price	
1 = white	0	
3 = black	0	
4 = graphite grey	0	
Other RAL colours	41	

Example Product code: 4009-1 = Square 250 interior, white, E27

SQUARE 270 INTERIOR



270 mm, LED			
Product code	Definition	Net price excl. VAT	EUR
4824-	15 W Bridgelux, 350mA		328
4825-	12 W Bridgelux, 350mA, downwards only		328

Select colour, colour temperature, etc. in the table below and construct the order code as shown below.							
Colour	Price	Colour temperature	Price	Dimming	Price	Protection class	Price
1 = white	0	927 = 2700 K, 90 Ra	0	V = 1-10 V	10	empty = class I	0
3 = black	0	930 = 3000 K, 90 Ra	0	D = DALI	20	K = class II	13
4 = graphite grey	0	940 = 4000 K, 90 Ra	0	S = switch	20		
Other RAL colours	41			R = bluetooth sensor	81		
Example Product code: 4824-1930 = Square 270 interior, white 15 W LED, 3000 K, 90 Ra, class I							

270 mm, E27 LED			
Product code	Definition	Net price excl. VAT	EUR
4010-	max 30 W, E27		199
4013-	max 30 W, E27, downwards only		199
1100-2	Philips Core Pro LED, 9 W, 2700 K, 80 Ra, 15,000 service hours		6
1100-3	Philips Core Pro LED, 9 W, 3000 K, 80 Ra, 15,000 service hours		6
1100-8	Philips Core Pro LED, 11 W, 2700 K, 80 Ra, 15,000 service hours		6
1100-7	Philips Core Pro LED, 13 W, 3000 K, 80 Ra, 15,000 service hours		6
1100-4	Philips Core Pro LED, 15 W, 2700 K, 80 Ra, 15,000 service hours		6
1100-6	A60 Deco Aurora LED dimmable, 7.5 W, 2700 K, 80 Ra, 20,000 service hours		11
We grant no discount on the lamps.			

Select colour, dimming, etc. in the table below and construct the order code as shown below.		
Colour	Price	
1 = white	0	
3 = black	0	
4 = graphite grey	0	
Other RAL colours	41	
Example Product code: 4010-1 = Square 270 interior, white, E27, class I		

Digits in Square 250 and 270

Laser cutting	Price
empty = no cutting	0
C = laser cutting	81
In case of laser cutting in the front, please add a "C" to the product code. Applies to all variants.	
Please take contact in case of pictogrammes.	

SQUARE 190 EXTERIOR

19

190 mm, LED			
Product code	Definition	Net price excl. VAT	EUR
6920-	8 W Bridgelux, 250 mA		274
6921-	11 W Bridgelux, 350 mA		274
6922-	6 W Bridgelux, 250 mA, downwards only		274
6923-	8 W Bridgelux, 350 mA, downwards only		274

Select colour, colour temperature, etc. in the table below and construct the order code as shown below.

Colour	Price	Colour temperature	Price	Dimming	Price	Protection class	Price
1 = white	0	927 = 2700 K, 90 Ra	0	V = 1-10 V	10	K = class II	0
3 = black	0	930 = 3000 K, 90 Ra	0	D = DALI	20		
4 = graphite grey	0	940 = 4000 K, 90 Ra	0				
8 = brushed copper	132						
17 = corten brown	0						
66 = noir 900	0						
Other RAL colours	41						

Example Product code: 6920-3927D = Square 190, black, 8 W LED, 2700 K, 90 Ra, Dali, class I

SQUARE 250 EXTERIOR

35

250 mm, LED			
Product code	Definition	Net price excl. VAT	EUR
6828-	10 W Bridgelux, 250 mA		313
6820-	15 W Bridgelux, 350 mA		313
6829-	8 W Bridgelux, 250 mA, downwards only		313
6826-	12 W Bridgelux, 350 mA, downwards only		313

Select colour, colour temperature, etc. in the table below and construct the order code as shown below.

Colour	Price	Colour temperature	Price	Dimming	Price	Protection class	Price
1 = white	0	927 = 2700 K, 90 Ra	0	V = 1-10 V	10	empty = class I	0
3 = black	0	930 = 3000 K, 90 Ra	0	D = DALI	20	K = class II	13
4 = graphite grey	0	940 = 4000 K, 90 Ra	0	R = bluetooth sensor	81		
8 = brushed copper	132						
9 = galvanised	23						
17 = corten brown	0						
66 = noir 900	0						
Other RAL colours	41						

Example Product code: 6820-3927D = Square 250, black, 15 W LED, 2700 K, 90 Ra, Dali, class I

250 mm, E27 LED			
Product code	Definition	Net price excl. VAT	EUR
6002-	max 30 W, E27		191
6006-	max 30 W, E27, downwards only		191
1100-2	Philips Core Pro LED, 9 W, 2700 K, 80 Ra, 15,000 service hours		6
1100-3	Philips Core Pro LED, 9 W, 3000 K, 80 Ra, 15,000 service hours		6
1100-8	Philips Core Pro LED, 11 W, 2700 K, 80 Ra, 15,000 service hours		6
1100-7	Philips Core Pro LED, 13 W, 3000 K, 80 Ra, 15,000 service hours		6
1100-4	Philips Core Pro LED, 15 W, 2700 K, 80 Ra, 15,000 service hours		6
We grant no discount on the lamps.			

Select colour in the table above and construct the order code as shown below.

Example Product code: 6002-1 = Square 250, white, E27, class I

SQUARE BOLLARD



H 1100 mm - without fitting			
Product code	Mounting	Net price excl. VAT	EUR
7016-	rooted base		610
7017-	flanged base		672
Select colour in the table below.			
Extra for colour	Price		
3 = black	41		
4 = graphite grey	41		
9 = galvanised	0		
66 = noir 900	41		
Other RAL colours	121		
Example Product code: 7016-4 = Square Bollard, rooted base, graphite grey			

SQUARE 270 EXTERIOR



270 mm, LED			
Product code	Definition	Net price excl. VAT	EUR
6824-	15 W Bridgelux, 350mA		342
6827-	20 W Bridgelux, 500mA		342
6825-	12 W Bridgelux, 350mA, downwards only		342

Select colour, colour temperature, etc. in the table below and construct the order code as shown below.							
Colour	Price	Colour temperature	Price	Dimming	Price	Protection class	Price
1 = white	0	927 = 2700 K, 90 Ra	0	V = 1-10 V	10	empty = class I	0
3 = black	0	930 = 3000 K, 90 Ra	0	D = DALI	20	K = class II	13
4 = graphite grey	0	940 = 4000 K, 90 Ra	0	R = bluetooth sensor	81		
8 = brushed copper	245						
9 = galvanised	26						
17 = corten brown	0						
66 = noir 900	0						
Other RAL colours	41						
Example Product code: 6822-8930 = Square 270, copper, 15 W LED, 3000 K, 90 Ra, class I							

Digits in Square 190, 250 and 270

Laser cutting	Price
empty = no cutting	0
C = laser cutting	81
In case of laser cutting in the front, please add a "C" to the product code. Applies to all variants.	
Please take contact in case of pictogrammes.	

STOA

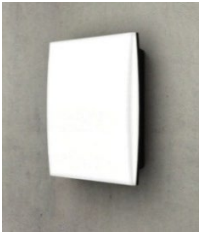

320 X 320 mm, LED			
Product code	Definition	Net price excl. VAT	EUR
6830-	10 W 350 mA		248
6831-	14 W 500 mA		248

Select colour, screen type, colour temperature, etc. in the table below and construct the order code as shown below.

Colour	Price	Screen type	Price	Colour temperature	Price	Dimming	Price
01 = raw anodized	0	A = acrylic glass	0	927 = 2700 K, 90 Ra	0	empty = no dimm.	0
1 = white	0	P = polycarbonate	0	930 = 3000 K, 90 Ra	0	V = 1-10 V	10
3 = black	0			940 = 4000 K, 90 Ra	0	D = DALI	20
Other RAL colours	54					S = Switch	20

Example Order code: 6830-1A830V = Stoa LED 10 W, white, acrylic screen, 3000 K 90 Ra, 1-10 V dimming, cl. I



Ø 280 mm, LED, downwards			
Product code	Definition	Net price excl. VAT	EUR
6872-	1 x Bridgelux V8, 6 W, 250 mA		274
6870-	1 x Bridgelux V8, 8 W, 350 mA		274
6871-	1 x Bridgelux V8, 11 W, 500 mA		274

Ø 280 mm, LED, up and downwards			
Product code	Definition	Net price excl. VAT	EUR
6874-	2 x Bridgelux V8, 10 W, 250 mA		290
6875-	2 x Bridgelux V8, 14 W, 350 mA		290
6876-	2 x Bridgelux V8, 20 W, 500 mA		290

Select colour and colour temperature in the table below and construct the order code as shown below.							
Colour	Price	Colour temperature	Price	Dimming	Price	Protection class	Price
9 = galvanised	0	927 = 2700 K, 90 Ra	0	V = 1-10 V	10	empty = class I	0
RAL colours	67	930 = 3000 K, 90 Ra	0	D = DALI	20	K = class II	20
		940 = 4000 K, 90 Ra	0	E = programmable	27		
Shade	Price						
empty = clear	0						
O = opal white	0						
H = top cover	13						
Example Order code: 6870-9930H = Tema Buen galvanised, 8 W LED, 3000 K, 90 Ra, clear shade with top cover							

Ø 280 mm, E27			
Product code	Definition	Net price excl. VAT	EUR
6071-	E27, max 52 W, max length 116 mm, max diameter 60 mm		214
1100-2	Philips Core Pro LED, 9 W, 2700 K, 80 Ra, 15,000 service hours		6
1100-3	Philips Core Pro LED, 9 W, 3000 K, 80 Ra, 15,000 service hours		6
1100-8	Philips Core Pro LED, 11 W, 2700 K, 80 Ra, 15,000 service hours		6
1100-7	Philips Core Pro LED, 13 W, 3000 K, 80 Ra, 15,000 service hours		6
1100-4	Philips Core Pro LED, 15 W, 2700 K, 80 Ra, 15,000 service hours		6
1100-6	A60 Deco Aurora LED dimmable, 7.5 W, 2700 K, 80 Ra, 20,000 service hours		11
We grant no discount on the lamps.			

Select colour and shade in the table below.			
Colour	Price	Shade	Price
9 = galvanised	0	empty = clear	0
RAL colours	67	H = top cover	13
		O = opal white	0
Example Order code: 6071-9 = Tema Buen galvanised, E27, clear shade			

YOYO SURFACE MOUNTED



Ø 225 mm, LED			
Product code	Definition	Net price excl. VAT	EUR
2922-	7 W Edge Lit, 350 mA		273
2919-	10 W Edge Lit, 500 mA		273
2918-	14 W Edge Lit, 700 mA		273
2923-	7 W Edge Lit, 350 mA, with uplight		273
2921-	10 W Edge Lit, 500 mA, with uplight		273
2920-	14 W Edge Lit, 700 mA, with uplight		273

Select colour, colour temperature, etc. in the table below and construct the order code as shown below.

Colour	Price	Screen type	Price	Colour temperature	Price	Dimming	Price
0 = raw untreated	0	empty = acrylate	0	927 = 2700 K, 90 Ra	0	empty = no dimm.	0
01 = raw anodized	0	M = micro prismatic	0	930 = 3000 K, 90 Ra	0	D = DALI-2	20
1 = white RAL 9010	0			940 = 4000 K, 90 Ra	0	T = Triac*	10
3 = black RAL 9005	0					* 350-500 mA only	
19 = alu-grey RAL 9006	0						
102 = yellow RAL 1032	0						
103 = orange RAL 2003	0						
104 = blue-green RAL 6004	0						
105 = squirrel grey RAL 7000	0						
Other RAL colours	27						

Example Item No.: 2922-1927 = Yoyo 225, 7 W, white, 2700 K 90 Ra



Ø 350 mm, LED			
Product code	Definition	Net price excl. VAT	EUR
2911-	16 W Edge Lit, 500 mA		352
2910-	23 W Edge Lit, 700 mA		352
2913-	16 W Edge Lit, 500 mA, with uplight		352
2912-	23 W Edge Lit, 700 mA, with uplight		352

Select colour, colour temperature, etc. in the table below and construct the order code as shown below.

Colour	Price	Screen type	Price	Colour temperature	Price	Dimming	Price
0 = raw untreated	0	empty = acrylate	0	927 = 2700 K, 90 Ra	0	empty = no dimm.	0
01 = raw anodized	0	M = micro prismatic	0	930 = 3000 K, 90 Ra	0	D = DALI-2	20
1 = white RAL 9010	0			940 = 4000 K, 90 Ra	0	R = bluetooth sens	81
3 = black RAL 9005	0			9WD* = TW, Dali-2, 90	74	T = Triac (500 mA)	10
19 = alu-grey RAL 9006	0			* Longer lead times		V = 1-10 V	10
102 = yellow RAL 1032	0						
103 = orange RAL 2003	0						
104 = blue-green RAL 6004	0						
105 = squirrel grey RAL 7000	0						
Other RAL colours	27						

Example Item No.: 2913-3M927 = Yoyo 350 w. uplight, 16 W, black, shade micro prismatic, 2700 K 90 Ra

YOYO SURFACE MOUNTED



Ø 535 mm, LED			
Product code	Definition	Net price excl. VAT	EUR
2914-	26 W Edge Lit, 500 mA		512
2915-	36 W Edge Lit, 700 mA		512
2916-	26 W Edge Lit, 500 mA, with uplight		512
2917-	36 W Edge Lit, 700 mA, with uplight		512

Select colour, colour temperature, etc. in the table below and construct the order code as shown below.							
Colour	Price	Screen type	Price	Colour temperature	Price	Dimming	Price
0 = raw untreated	0	empty = acrylate	0	927 = 2700 K, 90 Ra	0	empty = no dimm.	0
01 = raw anodized	0	M = micro prismatic	0	930 = 3000 K, 90 Ra	0	D = DALI-2	20
1 = white RAL 9010	0			940 = 4000 K, 90 Ra	0	R = bluetooth sens	81
3 = black RAL 9005	0			9WD* = TW, Dali-2, 90	94	T = Triac (350 mA)	10
19 = alu-grey RAL 9006	0			* Longer lead times		V = 1-10 V	10
102 = yellow RAL 1032	0						
103 = orange RAL 2003	0						
104 = blue-green RAL 6004	0						
105 = squirrel grey RAL 7000	0						
Other RAL colours	27						
Example Item No.: 2915-1M930D = Yoyo 535, 36 W, white, shade micro prismatic, 3000 K 90 Ra, Dali-2							

Extras			
Product code	Definition	Net price excl. VAT	EUR
1727-01	Kit set Yoyo 350 and 225, 3 pcs spacer tube for visible cable assembly		7
1727-02	Kit set Yoyo 535, 4 pcs spacer tube for visible cable assembly		7

YOYO PENDANT



Ø 350 mm, LED			
Product code	Definition	Net price excl. VAT	EUR
1853-	16 W Edge Lit, 500 mA		501
1854-	23 W Edge Lit, 700 mA		501
1857-	16 W Edge Lit, 500 mA, with uplight		529
1858-	23 W Edge Lit, 700 mA, with uplight		529

Select colour, colour temperature, etc. in the table below and construct the order code as shown below.

Colour	Price	Screen type	Price	Colour temperature	Price	Dimming	Price
0 = raw untreated	0	empty = acrylate	0	927 = 2700 K, 90 Ra	0	empty = no dimm.	0
01 = raw anodized	0	M = micro prismatic	0	930 = 3000 K, 90 Ra	0	D = DALI-2	20
1 = white RAL 9010	0			940 = 4000 K, 90 Ra	0	R = bluetooth sens	81
3 = black RAL 9005	0			9WD* = TW, Dali-2, 90	74	T = Triac (500 mA)	10
19 = alu-grey RAL 9006	0			* Longer lead times		V = 1-10 V	10
102 = yellow RAL 1032	0					Colour of lead	Price
103 = orange RAL 2003	0					empty = white	0
104 = blue-green RAL 6004	0					Y = black	0
105 = squirrel grey RAL 7000	0						
Other RAL colours	40						

Example Item No.: 1853-1M930 = Yoyo 350 pendant, 16 W, white, shade prismatic, 2700 K 90 Ra, white lead



Ø 535 mm, LED			
Product code	Definition	Net price excl. VAT	EUR
1850-	26 W Edge Lit, 500 mA		666
1851-	36 W Edge Lit, 700 mA		666
1855-	26 W Edge Lit, 500 mA, with uplight		709
1856-	36 W Edge Lit, 700 mA, with uplight		709

Select colour, colour temperature, etc. in the table below and construct the order code as shown below.

Colour	Price	Screen type	Price	Colour temperature	Price	Dimming	Price
0 = raw untreated	0	empty = acrylate	0	927 = 2700 K, 90 Ra	0	empty = no dimm.	0
01 = raw anodized	0	M = micro prismatic	0	930 = 3000 K, 90 Ra	0	D = DALI-2	20
1 = white RAL 9010	0			940 = 4000 K, 90 Ra	0	R = bluetooth sens	81
3 = black RAL 9005	0			9WD* = TW, Dali-2, 90	94	T = Triac (350 mA)	10
19 = alu-grey RAL 9006	0			* Longer lead times		V = 1-10 V	10
102 = yellow RAL 1032	0					Colour of lead	Price
103 = orange RAL 2003	0					empty = white	0
104 = blue-green RAL 6004	0					Y = black	0
105 = squirrel grey RAL 7000	0						
Other RAL colours	40						

Example Item No.: 1851-3M930Y = Yoyo 535 pendant, 36 W, black, shade prismatic, 3000 K 90 Ra, black lead

Extras			
Product code	Description	Nett price excl. VAT	EUR
1720-1	Canopy with suspension fitting, white		13
1720-3	Canopy with suspension fitting, black		13

YOYO LINE



Yoyo Line 1300			
Product code	Definition (Lumen-out 4000K)	Net price excl. VAT	EUR
5850-	Downlight 100% (4000 lumen-out)		618
5851-	Downlight 100% (1500 lumen-out)		618
5852-	Downlight 40% / Uplight 60%, Clear top (5500 lumen-out)		665
5854-	Downlight 40% / Uplight 60%, Clear top (3250 lumen-out)		665
5856-	Downlight 40% / Uplight 60%, Opal top (5300 lumen-out)		665
5858-	Downlight 40% / Uplight 60%, Opal top (2500 lumen-out)		665

Select colour, colour temperature, etc. in the table below and construct the order code as shown below.

Colour	Price	Screen type	Price	Colour temperature	Price	Dimming	Price
0 = raw untreated	0	P = Prismatic down	0	927 = 2700 K, 90 Ra	0	D = DALI-2	0
01 = raw anodized	40			930 = 3000 K, 90 Ra	0		
1 = white RAL 9010	0			940 = 4000 K, 90 Ra	0		
3 = black RAL 9005	40						
19 = alu-grey RAL 9006	40					Colour of lead	Price
102 = yellow RAL 1032	40					empty = white	0
103 = orange RAL 2003	40					Y = black	0
104 = blue-green RAL 6004	40						
105 = squirrel grey RAL 7000	40						
Other RAL colours	67						

Yoyo Line 1900			
Product code	Definition (Lumen-out 4000K)	Net price excl. VAT	EUR
5860-	Downlight 100% (4800 lumen-out)		618
5861-	Downlight 100% (2200 lumen-out)		618
5862-	Downlight 40% / Uplight 60%, Clear top (5900 lumen-out)		665
5864-	Downlight 40% / Uplight 60%, Clear top (3400 lumen-out)		665
5866-	Downlight 40% / Uplight 60%, Opal top (5300 lumen-out)		665
5868-	Downlight 40% / Uplight 60%, Opal top (3700 lumen-out)		665

Select colour, colour temperature, etc. in the table below and construct the order code as shown below.

Colour	Price	Screen type	Price	Colour temperature	Price	Dimming	Price
0 = raw untreated	0	P = Prismatic down	0	927 = 2700 K, 90 Ra	0	D = DALI-2	0
01 = raw anodized	40			930 = 3000 K, 90 Ra	0		
1 = white RAL 9010	0			940 = 4000 K, 90 Ra	0		
3 = black RAL 9005	40						
19 = alu-grey RAL 9006	40					Colour of lead	Price
102 = yellow RAL 1032	40					empty = white	0
103 = orange RAL 2003	40					Y = black	0
104 = blue-green RAL 6004	40						
105 = squirrel grey RAL 7000	40						
Other RAL colours	67						

YOYO OUTDOOR

Yoyo Outdoor Ø 350 mm, LED			
Product code	Definition	Net price excl. VAT	EUR
6930-	11 W, 350 mA		336
6931-	15 W, 500 mA		336

Select colour, colour temperature, etc. in the table below and construct the order code as shown below.

Colour	Price	Screen type	Price	Colour temperature	Price	Dimming	Price
0 = raw untreated	0	blank = opal acrylic	0	927 = 2700 K, 90 Ra	0	empty = no dimm.	0
01 = raw anodized	0		0	930 = 3000 K, 90 Ra	0	D = DALI-2	20
1 = white RAL 9010	0			940 = 4000 K, 90 Ra	0	R = bluetooth sensor	81
3 = black RAL 9005	27					V = 1-10 V	10
19 = alu-grey RAL 9006	27						
102 = yellow RAL 1032	27						
103 = orange RAL 2003	27						
104 = blue-green RAL 600	27						
105 = squirrel grey RAL 70	27						
Other RAL colours	40						

PELÉE RECESSED



Ø 250 mm recessed, LED			
Product code	Definition	Net price excl. VAT	EUR
2837-	10 W LED 213, 350 mA		313
2838-	14 W LED 213, 500 mA		313

Select colour, colour temperature, etc. in the table below and construct the order code as shown below.

Colour	Price	Screen type	Price	Colour temperature	Price	Dimming	Price
0 = raw untreated	0	empty = acrylate	0	927 = 2700 K, 90 Ra	0	empty = no dimm.	0
01 = raw anodized	0	M = micro prismatic	0	930 = 3000 K, 90 Ra	0	V = 1-10 V	10
1 = white	0			940 = 4000 K, 90 Ra	0	D = DALI	20
3 = sandblasted	0			9WD = TW, Dali, 90 Ra	74		
9 = alu-grey	0						
17 = corten brown	0						
66 = noir 900	0						
Other RAL colours	40						

Example Order code: 2837-19WD = Pelée 250 recessed, 10 W, white, tunable white, 90 Ra, Dali

Extras			
Product code	Description	Net price excl. VAT	EUR
2832-20	Reinforcement for soft ceilings, Pelée 250		27



Ø 385 mm recessed, LED			
Product code	Definition	Net price excl. VAT	EUR
2840-	17 W LED 324, 500 mA		381
2841-	23 W LED 324, 700 mA		381
2843-	33 W LED 324, 1050 mA, incl. Dali driver		434

Select colour, colour temperature, etc. in the table below and construct the order code as shown below.

Colour	Price	Screen type	Price	Colour temperature	Price	Dimming	Price
0 = raw untreated	0	empty = acrylate	0	927 = 2700 K, 90 Ra	0	empty = no dimm.	0
01 = raw anodized	0	M = micro prismatic	0	930 = 3000 K, 90 Ra	0	V = 1-10 V	10
1 = white	0			940 = 4000 K, 90 Ra	0	D = DALI	20
3 = sandblasted	0			9WD = TW, Dali, 90 Ra	94		
9 = alu-grey	0						
17 = corten brown	0						
66 = noir 900	0						
Other RAL colours	40						

Example Order code: 2840-66M930D = Pelée 385 recessed, 17 W, noir 900, micro prismatic screen, 3000 K 90 Ra, Dali

Extras			
Product code	Description	Net price excl. VAT	EUR
2834-20	Reinforcement for soft ceilings, Pelée 385		27

PELÉE SURFACE MOUNTED



Ø 250 mm surface-mounted, LED			
Product code	Definition	Net price excl. VAT	EUR
2880-	10 W LED 213, 350 mA		313
2881-	14 W LED 213, 500 mA		313

Select colour, colour temperature, etc. in the table below and construct the order code as shown below.

Colour	Price	Screen type	Price	Colour temperature	Price	Dimming	Price
0 = raw untreated	0	empty = acrylate	0	927 = 2700 K, 90 Ra	0	empty = no dimm.	0
01 = raw anodized	0	M = micro prismatic	0	930 = 3000 K, 90 Ra	0	V = 1-10 V	10
1 = white	0			940 = 4000 K, 90 Ra	0	D = DALI	20
9 = alu-grey	0			9WD = TW, Dali, 90 Ra	74		
17 = corten brown	0						
66 = noir 900	0						
Other RAL colours	40						

Example Order code: 2880-99WD = Pelée 250 surface-mounted, 10 W, alu-grey, tunable white, Dali



Ø 385 mm surface-mounted, LED			
Product code	Definition	Net price excl. VAT	EUR
2886-	17 W LED 324, 500 mA		381
2887-	23 W LED 324, 700 mA		381
2888-	33 W LED 324, 1050 mA, incl. Dali driver		434

Select colour, colour temperature, etc. in the table below and construct the order code as shown below.

Colour	Price	Screen type	Price	Colour temperature	Price	Dimming	Price
0 = raw untreated	0	empty = acrylate	0	927 = 2700 K, 90 Ra	0	empty = no dimm.	0
01 = raw anodized	0	M = micro prismatic	0	930 = 3000 K, 90 Ra	0	V = 1-10 V	10
1 = white	0			940 = 4000 K, 90 Ra	0	D = DALI	20
9 = alu-grey	0			9WD = TW, Dali, 90 Ra	94		
17 = corten brown	0						
66 = noir 900	0						
Other RAL colours	40						

Example Order code: 2886-66930V = Pelée 385 surface-mounted, 17 W, noir 900, 3000 K 90 Ra, 1-10 V dimming

PELÉE DOWNLIGHT



Ø 160 mm, LED			
Product code	Definition	Net price excl. VAT	EUR
2830-	8 W V8, 500 mA		214
2831-	11 W V8, 700 mA		214
2829-	16 W V8, 500 mA		214

Select colour, colour temperature, etc. in the table below and construct the order code as shown below.

Colour	Price	Colour temperature	Price	Dimming	Price		
0 = raw untreated	0	927 = 2700 K, 90 Ra	0	empty = no dimm.	0		
01 = raw anodized	0	930 = 3000 K, 90 Ra	0	V = 1-10 V	10		
1 = white	0	940 = 4000 K, 90 Ra	0	D = DALI	20		
9 = alu-grey	0						
17 = corten brown	0						
66 = noir 900	0						
Other RAL colours	40						

Example Order code: 2831-9930V = Pelée Downlight, 17 watts, alu-grey, 3000 K 90 Ra, 1-10 V dimming

Extras			
Product code	Description	Net price excl. VAT	EUR
2830-016	Reinforcement for soft ceilings, Pelée 160		27

PELÉE PENDANT



Ø 385 mm LED downwards			
Product code	Definition	Net price excl. VAT	EUR
1840-	17 W LED 324, 500 mA		443
1841-	23 W LED 324, 700 mA		443
1844-	33 W LED 324, 1050 mA, incl. Dali driver		496

Ø 385 mm LED up and downwards			
Product code	Definition	Net price excl. VAT	EUR
1842-	22 W LED, 500 mA		518
1843-	30 W LED, 700 mA		518
1845-	40 W LED, 950 mA, incl. Dali driver		572

Select colour, colour temperature, etc. in the table below and construct the order code as shown below.

Colour	Price	Screen type	Price	Colour temperature	Price	Dimming	Price
0 = raw untreated	0	empty = acrylate	0	927 = 2700 K, 90 Ra	0	empty = no dimm.	0
01 = raw anodized	0	M = micro prismatic	0	930 = 3000 K, 90 Ra	0	V = 1-10 V	10
1 = white	0			940 = 4000 K, 90 Ra	0	D = DALI	20
9 = alu-grey	0			9WD = TW, Dali, 90 Ra	94		
17 = corten brown	0					Colour of lead	Price
66 = noir 900	0					empty = white	0
Other RAL colours	40					Y = black	0

Example Order code: 1842-9927 = Pelée pendant Uplight, 22 watts, alu-grey, 2700 K 90 Ra

Extras			
Product code	Description	Net price excl. VAT	EUR
1720-1	Canopy with suspension fitting, white		13
1720-3	Canopy with suspension fitting, black		13

PELÉE WALL



L 320 mm, LED linear			
Product code	Definition	Net price excl. VAT	EUR
6891-	9 W LED, 350 mA		214
6892-	13 W LED, 500 mA		214

Select colour, colour temperature, etc. in the table below and construct the order code as shown below.

Colour	Price	Colour temperature	Price	Dimming	Price	Classification	Price
0 = raw untreated	0	927 = 2700 K, 90 Ra	0	empty = no dimm.	0	empty = class I	0
01 = raw anodized	0	930 = 3000 K, 90 Ra	0	V = 1-10 V	10	K = class II	0
1 = white	0	940 = 4000 K, 90 Ra	0	D = DALI-2	20		
9 = alu-grey	0			R = bluetooth sensor	81		
17 = corten brown	0						
66 = noir 900	0						
Other RAL colours	40						

Example Order code: 6892-1930D = Pelée Wall, 13 W, white, 3000 K, 90 Ra, Dali-2, class I



Base for visible cables			
Product code	Definition	Net price excl. VAT	EUR
1723-	Base for cable entry on wall		54

Add one of the colour codes below to the product code.

Colour	Price
0 = raw untreated	0
01 = raw anodized	0
1 = white	0
4 = graphite grey	0
9 = alu-grey	0
17 = corten brown	0
66 = noir 900	0

PELÉE LINE



L 1200 mm, LED, Dali, downwards: 100%			
Product code	Definition	Net price excl. VAT	EUR
5109-	2000 lm		549
5101-	3000 lm		549
5102-	4000 lm		549

L 1200 mm, LED, Dali, up/down: 35/65			
Product code	Definition	Net price excl. VAT	EUR
5103-	5000 lm (1750/3250)		594
5104-	6000 lm (1800/4200)		594

L 1200 mm, LED, Dali, up/down: 50/50			
Product code	Definition	Net price excl. VAT	EUR
5105-	4000 lm (2000/2000)		594
5106-	6000 lm (3000/3000)		594

L 1200 mm, LED, Dali, up/down: 65/35			
Product code	Definition	Net price excl. VAT	EUR
5107-	5000 lm (3250/1750)		594
5108-	6000 lm (4200/1800)		594

Select colour, colour temperature etc. in the table.							
Colour	Price	Shade	Price	Colour temperature	Price	Colour of lead	Price
0 = raw untreated	0	M = mikroprismatic	0	827 = 2700 K, 80 Ra	0	empty = white	0
01 = raw anodized	0			930 = 3000 K, 90 Ra	0	Y = black	0
1 = white	0			940 = 4000 K, 90 Ra	0		
9 = alu-grey	0						
17 = corten brown	0						
66 = noir 900	0						
Other RAL colours	134						
Example order code: 5103-66M930 = Pelée Line 1200, 35/65, 4000 lm, noir 900, prismatic shade, 3000 K							

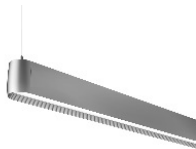

L 1800 mm, LED, Dali, downwards: 100%			
Product code	Definition	Net price excl. VAT	EUR
5801-	3000 lm		723
5802-	4500 lm		723
5803-	6000 lm		723

L 1800 mm, LED, Dali, up/down: 35/65			
Product code	Definition	Net price excl. VAT	EUR
5804-	7500 lm (2625/4875)		780
5805-	9000 lm (3150/5850)		780

L 1800 mm, LED, Dali, up/down: 50/50			
Product code	Definition	Net price excl. VAT	EUR
5806-	6000 lm (3000/3000)		780
5807-	9000 lm (4500/4500)		780

L 1800 mm, LED, Dali, up/down: 65/35			
Product code	Definition	Net price excl. VAT	EUR
5808-	7500 lm (4875/2625)		780
5809-	9000 lm (5850/3150)		780

Select colour, colour temperature etc. in the table.							
Colour	Price	Shade	Price	Colour temperature	Price	Colour of lead	Price
0 = raw untreated	0	M = mikroprismatic	0	827 = 2700 K, 80 Ra	0	empty = white	0
01 = raw anodized	0			930 = 3000 K, 90 Ra	0	Y = black	0
1 = white	0			940 = 4000 K, 90 Ra	0		
9 = alu-grey	0						
17 = corten brown	0						
66 = noir 900	0						
Other RAL colours	134						
Example order code: 5804-9M930 = Pelée Line 1800, 35/65, alu-grey, prismatic shade, 3000 K							

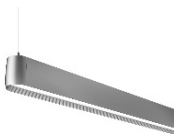

L 2350 mm, LED, Dali			
Product code	Definition	Net price excl. VAT	EUR
5812-	8000 lm, 100% downwards		1068
5815-	12000 lm, 35/65 up/down		1125
5817-	12000 lm, 50/50 up/down		1125
5819-	12000 lm, 65/35 up/down		1125
Lower luminous power upon request			

Select colour, colour temperature etc. in the table.

Colour	Price	Shade	Price	Colour temperature	Price	Colour of lead	Price
0 = raw untreated	0	M = mikroprismatic	0	827 = 2700 K, 80 Ra	0	empty = white	0
01 = raw anodized	0			930 = 3000 K, 90 Ra	0	Y = black	0
1 = white	0			940 = 4000 K, 90 Ra	0		
9 = alu-grey	0						
17 = corten brown	0						
66 = noir 900	0						
Other RAL colours	134						

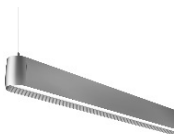

L 2900 mm, LED, Dali			
Product code	Definition	Net price excl. VAT	EUR
5823-	10000 lm, 100% downwards		1185
5825-	15000 lm, 35/65 up/down		1242
5827-	15000 lm, 50/50 up/down		1242
5829-	15000 lm, 65/35 up/down		1242
Lower luminous power upon request			

Select colour, colour temperature etc. in the table.

Colour	Price	Shade	Price	Colour temperature	Price	Colour of lead	Price
0 = raw untreated	0	M = mikroprismatic	0	827 = 2700 K, 80 Ra	0	empty = white	0
01 = raw anodized	0			930 = 3000 K, 90 Ra	0	Y = black	0
1 = white	0			940 = 4000 K, 90 Ra	0		
9 = alu-grey	0						
17 = corten brown	0						
66 = noir 900	0						
Other RAL colours	134						

H+M RECESSED



Ø 300 mm, LED			
Product code	Definition	Net price excl. VAT	EUR
2860-	11 W LED 244, 350 mA		324
2861-	15 W LED 244, 500 mA		324

Select colour, screen type, colour temperature, etc. in the table below and construct the order code as shown below.

Colour	Price	Screen type	Price	Colour temperature	Price	Dimming	Price
0 = raw untreated	0	P = polycarbonate	0	927 = 2700 K, 90 Ra	0	empty = no dimm.	0
1 = white	0	M = micro prismatic acryl	0	930 = 3000 K, 90 Ra	0	V = 1-10 V	10
3 = black	0			940 = 4000 K, 90 Ra	0	D = DALI	20
9 = grey metallic	0			9WD = TW, Dali, 90 Ra	74		
Other RAL colours	27						

Example Order code: 2861-9P930D = H+M 300, 15 W, grey metallic, polycarbonate screen, 3000 K, Dali control

Extras			
Product code	Description	Net price excl. VAT	EUR
2860-001	Reinforcement for soft ceilings, H+M 300		27



Ø 380 mm, LED			
Product code	Definition	Net price excl. VAT	EUR
2866-	17 W LED 324, 500 mA		404
2867-	23 W LED 324, 700 mA		404
2868-	33 W LED 324, 1050 mA, incl. Dali driver		458

Select colour, screen type, colour temperature, etc. in the table below and construct the order code as shown below.

Colour	Price	Screen type	Price	Colour temperature	Price	Dimming	Price
0 = raw untreated	0	P = polycarbonate	0	927 = 2700 K, 90 Ra	0	empty = no dimm.	0
1 = white	0	M = micro prismatic acryl	0	930 = 3000 K, 90 Ra	0	V = 1-10 V	10
3 = black	0			940 = 4000 K, 90 Ra	0	D = DALI	20
9 = grey metallic	0			9WD = TW, Dali, 90 Ra	94		
Other RAL colours	27						

Example Order code: 2867-1P9WD = H+M 380, 23 W, white, polycarbonate screen, 3000 K, tunable white, Dali

Extras			
Product code	Description	Net price excl. VAT	EUR
2834-20	Reinforcement for soft ceilings, H+M 380		27

H+M SURFACE-MOUNTING



Ø 300 mm, LED			
Product code	Definition	Net price excl. VAT	EUR
2870-	11 W LED 244, 350 mA		286
2871-	15 W LED 244, 500 mA		286

Select colour, colour temperature, etc. in the table below and construct the order code as shown below.

Colour	Price	Screen type	Price	Colour temperature	Price	Dimming	Price
0 = raw untreated	0	P = polycarbonate	0	927 = 2700 K, 90 Ra	0	empty = no dimm.	0
1 = white	0	MP = micro prismatic	40	930 = 3000 K, 90 Ra	0	V = 1-10 V	10
3 = black	0			940 = 4000 K, 90 Ra	0	D = DALI	20
9 = grey metallic	0			9WD = TW, Dali, 90 Ra	74		
Other RAL colours	40						
Spings for wall m.	Price						
F = two springs	6						

Example Order code: 2870-3P9WD = H+M surface mount 300, 11 W, black, tunable white, 90 Ra, Dali



Ø 380 mm, LED			
Product code	Definition	Net price excl. VAT	EUR
2876-	17 W LED 324, 500 mA		348
2877-	23 W LED 324, 700 mA		348
2878-	33 W LED 324, 1050 mA, incl. Dali driver		402

Select colour, colour temperature, etc. in the table below and construct the order code as shown below.

Colour	Price	Screen type	Price	Colour temperature	Price	Dimming	Price
0 = raw untreated	0	P = polycarbonate	0	927 = 2700 K, 90 Ra	0	empty = no dimm.	0
1 = white	0	MP = micro prismatic	40	930 = 3000 K, 90 Ra	0	V = 1-10 V	10
3 = black	0			940 = 4000 K, 90 Ra	0	D = DALI	20
9 = grey metallic	0			9WD = TW, Dali, 90 Ra	94		
Other RAL colours	40						
Spings for wall m.	Price						
F = two springs	6						

Example Order code: 2877-1P930D = H+M surface mount 380, 23 W, white, 3000 K, 90 Ra, Dali

H+M PENDANT



Ø 300 mm, LED			
Product code	Definition	Net price excl. VAT	EUR
1812-	11 W LED 244, 350 mA		334
1813-	15 W LED 244, 500 mA		334

Select colour, colour temperature, etc. in the table below and construct the order code as shown below.

Colour	Price	Colour temperature	Price	Dimming	Price	Colour of lead	Price
0 = raw untreated	0	927 = 2700 K, 90 Ra	0	empty = no dimming	0	empty = white	0
1 = white	0	930 = 3000 K, 90 Ra	0	V = 1-10 V	15	Y = black	0
3 = black	0	940 = 4000 K, 90 Ra	0	D = DALI	20		
4 = graphite grey	0	9WD = TW, Dali, 90 Ra	74				
Other RAL colours	54						

Example Order code: 1812-39WD = H+M pendant 300, 11 W, black, tunable white, 90 Ra, Dali



Ø 380 mm, LED			
Product code	Definition	Net price excl. VAT	EUR
1818-	17 W LED 324, 500 mA		380
1819-	23 W LED 324, 700 mA		380
1820-	33 W LED 324, 1050 mA, incl. Dali driver		432

Select colour, colour temperature, etc. in the table below and construct the order code as shown below.

Colour	Price	Colour temperature	Price	Dimming	Price	Colour of lead	Price
0 = raw untreated	0	927 = 2700 K, 90 Ra	0	empty = no dimming	0	empty = white	0
1 = white	0	930 = 3000 K, 90 Ra	0	V = 1-10 V	15	Y = black	0
3 = black	0	940 = 4000 K, 90 Ra	0	D = DALI	20		
4 = graphite grey	0	9WD = TW, Dali, 90 Ra	94				
Other RAL colours	54						

Example Order code: 1818-1927D = H+M pendant 380, 17 W, white, 2700 K, 90 Ra, Dali



Ø 300 mm, E27			
Product code	Definition	Net price excl. VAT	EUR
1006-	E27, max 57 W, max length: 95 mm		214



Ø 380 mm, E27			
Product code	Definition	Net price excl. VAT	EUR
1008-	E27, max 77 W, max length: 140 mm		243

Select colour in the table below and construct the order code as shown below.

Colour	Price	Colour of lead	Price				
0 = raw untreated	0	empty = white	0				
1 = white	0	Y = black	0				
3 = black	0						
4 = graphite grey	0						
Other RAL colours	54						

Example Order code: 1006-1 = H+M pendant 300, E27, white

PUNKT LAMP



Ø 65 mm, LED with driver			
Product code	Definition	Net price excl. VAT	EUR
2890-	5 W V6, 350 mA		67

Select colour and colour temperature in the table below and construct the order code as shown below.

Colour	Price	Colour temperature	Price	Dimming	Price
2 = white w. glass	0	927 = 2700 K, 90 Ra	0	empty = no dimming	0
9 = alu w. glass	0	930 = 3000 K, 90 Ra	0	T = Triac	0
		940 = 4000 K, 90 Ra	0	V = 1-10 V	17
				D = DALI	24

Example Order code: 2890-2927V = Punkt Lamp Ø65, 5 W, white w. glass, 2700 K, 1-10 V dimming

Extras			
Product code	Description	Net price excl. VAT	EUR
2700-20	Ring for soft ceilings		7



Ø 90 mm, LED			
Product code	Definition	Net price excl. VAT	EUR
2891-	5 W V6, 350 mA		138
2895-	7 W V6, 500 mA		138

Select colour and colour temperature in the table below and construct the order code as shown below.

Colour	Price	Colour temperature	Price	Dimming	Price
2 = white w. glass	0	927 = 2700 K, 90 Ra	0	empty = no dimming	0
9 = alu w. glass	0	930 = 3000 K, 90 Ra	0	V = 1-10 V	0
		940 = 4000 K, 90 Ra	0	D = DALI	8

Example Order code: 2891-2927 = Punkt Lamp Ø90, 5 W, white w. glass, 2700 K

Ø 90 mm, other than LED			
Product code	Definition	Net price excl. VAT	EUR
2901-	GU10		60

Select colour in the table below and construct the order code as shown below.

Colour	Price
2 = white w. glass	0
9 = alu w. glass	0

Example Order Code: 2901-2 = Punkt Lamp Ø90, GU10 base, white w. glass

Extras			
Product code	Description	Net price excl. VAT	EUR
2010-20	Ring for soft ceilings		7



Ø 110 mm, LED			
Product code	Definition	Net price excl. VAT	EUR
2899-	6 W V8, 250 mA		172
2892-	8 W V8, 350 mA		172
2896-	11 W V8, 500 mA		172

Select colour and colour temperature in the table below and construct the order code as shown below.					
Colour	Price	Colour temperature	Price	Dimming	Price
2 = white w. glass	0	927 = 2700 K, 90 Ra	0	empty = no dimming	0
9 = alu w. glass	0	930 = 3000 K, 90 Ra	0	V = 1-10 V	10
		940 = 4000 K, 90 Ra	0	D = DALI	20
Example Order code: 2892-2927V = Punkt Lamp Ø110, 9 W, white w. glass, 2700 K, 1-10 V dimming					

Extras			
Product code	Description	Net price excl. VAT	EUR
2020-20	Ring for soft ceilings		7



Ø 150 mm, LED			
Product code	Definition	Net price excl. VAT	EUR
2893-	11 W V8, 500 mA		214
2898-	16 W V8, 700 mA		214

Select colour and colour temperature in the table below and construct the order code as shown below.					
Colour	Price	Colour temperature	Price	Dimming	Price
2 = white w. glass	0	927 = 2700 K, 90 Ra	0	empty = no dimming	0
9 = alu w. glass	0	930 = 3000 K, 90 Ra	0	V = 1-10 V	10
		940 = 4000 K, 90 Ra	0	D = DALI	20
Example Order code: 2898-9930D = Punkt Lamp Ø150, 17 W, alu w. glass, 3000 K, Dali dimming					

Extras			
Product code	Description	Net price excl. VAT	EUR
2030-20	Ring for soft ceilings		8
20152	Glass shade, 3 mm		11



Ø 200 mm, LED			
Product code	Definition	Net price excl. VAT	EUR
2894-	17 W Vero18, 500 mA		243
2897-	24 W Vero18, 700 mA		243

Select colour and colour temperature in the table below and construct the order code as shown below.					
Colour	Price	Colour temperature	Price	Dimming	Price
2 = white w. glass	0	927 = 2700 K, 90 Ra	0	empty = no dimming	0
9 = alu w. glass	0	930 = 3000 K, 90 Ra	0	V = 1-10 V	10
		940 = 4000 K, 90 Ra	0	D = DALI	20
Example Order Code: 2897-9927D = Punkt Lamp Ø200, 24 W, alu w. glass, 2700 K, Dali dimming					

Extras			
Product code	Description	Net price excl. VAT	EUR
2040-20	Ring for soft ceilings		11
20202	Glass shade, 3 mm		12

LED modules - indoor & wall fittings

The item number of an LED module consists of four digits followed by the code for colour temperature and CRI plus dimming type, if any. There is no extra charge for 1-10 V dimming, whereas the Dali control will be charged with EUR 13.-

The prices below are net-net prices. There is no discount on these prices.

	Item No.	LED	Comment 1	Comment 2	EUR
H+M Ø300 downlights	1901-	11 W 350 mA			97
	1902-	15 W 500 mA			97
H+M Ø380 downlights	1903-	17 W 500 mA			118
	1904-	23 W 700 mA			118
	1968-	33 W 1050 mA, Dali			169
H+M Pendant Ø300	1905-	11 W 350 mA	From CFL		110
	1906-	15 W 500 mA	From CFL		110
H+M Pendant Ø380	1907-	17 W 500 mA	From CFL		138
	1908-	23 W 700 mA	From CFL		138
STOA	1909-	10 W 350 mA	Interior and exterior		77
	1910-	14 W 500 mA			77
QUARTO 270	1972-	6 W 250 mA	Interior and exterior		48
	1911-	8 W 350 mA			48
	1912-	11 W 500 mA			48
QUARTO 380	1980-	8 W 350 mA			48
	1913-	11 W 500 mA			48
	1914-	16 W 700 mA			48
SQUARE 250	1971-	10 W 250 mA	Interior and exterior		87
	1915-	15 W 350 mA	Models before 2004 to be quoted		87
SQUARE 250 downwards	1977-	8 W 250 mA	Interior and exterior		87
	1950-	12 W 350 mA			87
SQUARE 270	1916-	15 W 350 mA	Models before 2015 only	Wall box included	103
	1954-	20 W 500 mA	Models before 2015 only	Wall box included	103
	1915-	15 W 350 mA	Models after 2015		87
	1978-	20 W 500 mA	Models after 2015		87
SQUARE 270 downwards	1977-	8 W 250 mA	Models after 2015 only		87
	1950-	12 W 350 mA	Models after 2015 only		87
NYX 190 WALL	1974-	6 W 250 mA			58
	1917-	8 W 350 mA			58
	1918-	11 W 500 mA			58
TEMA BUEN downwards only	1929-	8 W 350 mA	Models after 1996 only		59
	1930-	11 W 500 mA	Models after 1996 only		59
TEMA BUEN up and downwards	1981-	10 W 250 mA	Models after 1996 only		74
	1951-	14 W 350 mA	Models after 1996 only		74
TEMA SIGTEN	1952-	20 W 500 mA	Models after 1996 only		74
	1931-	8 W 350 mA	Models after 1996 only		59
TEMA KLAMPEN 205	1932-	11 W 500 mA	Models after 1996 only		59
	1933-	8 W 250 mA	Models after 1996 only		83
TEMA KLAMPEN 250	1934-	12 W 350 mA	Models after 1996 only		83
	1935-	16 W 500 mA	Models after 1996 only		83
TEMA GRØNNEGADE 385	1936-	8 W 250 mA	Models after 1996 only		86
	1937-	11 W 350 mA	Models after 1996 only		86
TEMA GRØNNEGADE 490	1938-	12 W 350 mA	Models after 1996 only		122
	1939-	16 W 500 mA	Models after 1996 only		122

LED modules - bollards and pole top luminaires

The item number of an LED module consists of four digits followed by the code for colour temperature and CRI plus dimming type, if any. There is no extra charge for 1-10 V dimming, whereas the Dali control will be charged with EUR 13.-
Extra charge for class II is EUR 13.-

The prices below are net-net prices. There is no discount on these prices.

NYX 190 BOLLARD	1973-	6 W 250 mA	Not for DragonEye versions (sold until April 2013)		87
class I and II	1919-	8 W 350 mA	Same module for class I and II luminaires.		87
	1955-	11 W 500 mA			87
	1960-	16 W 700 mA			87
NYX 330 COMFORT	1920-	32 W, 2x6 DA	Including brackets and reflector	Programmable	193
NYX 330 FASTFLEX T3	1921-	40 W, high lumen	Including brackets and reflector	Programmable	193
NYX 330 FASTFLEX T3	1946-	22 W, low lumen	Including brackets and reflector	Programmable	193
NYX 330 FASTFLEX SCL	1969-	40 W, high lumen	Including brackets and reflector	Programmable	193
NYX 330 FASTFLEX SCL	1970-	22 W, low lumen	Including brackets and reflector	Programmable	193
NYX 450	To be quoted				
STICKS 900 single	1923-	8 W, 500 mA	including connection box		346
	1924-	11 W, 700 mA	including connection box		346
STICKS 900 double	1925-	15 W, 500 mA	including connection box		387
	1926-	20 W, 700 mA	including connection box		387
TEMA BOLLARD 1000	1975-	8 W 250 mA	Models after 1996 only	Including shade and sealing for base li	132
without door	1940-	12 W 350 mA	Models after 1996 only	Including shade and sealing for base li	132
	1941-	16 W 500 mA	Models after 1996 only	Including shade and sealing for base li	132
TEMA BOLLARD 1000	1976-	8 W 250 mA	Models after 1996 only	Including shade and sealing for base li	235
with door, option for cl. II	1964-	12 W 350 mA	Models after 1996 only	Including shade and sealing for base li	235
	1965-	16 W 500 mA	Models after 1996 only	Including shade and sealing for base li	235
Brackets for old models	12-045		Models before 1996 only	For pre 1996 models	17
TEMA BOLLARD 1100	1942-	12 W 350 mA		Including sealing for base lid	195
	1943-	16 W 500 mA		Including sealing for base lid	195
TEMA PARK	1944-	17 W 500 mA	Models after 1996 only	Including top plate, shade and sealing	258
	1945-	24 W 700 mA	Models after 1996 only	Including top plate, shade and sealing	258

COLUMNS FOR MULTIPLE NYX 330

Five standard solutions with two and three lanterns respectively are described in data sheet at www.focus-lighting.dk

For 3 mid-column lanterns

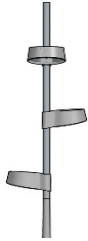

6.6 meter galvanised column for Multiple Nyx, 4.8 m conical with 1.8 m cylindrical extender			
Product code	Mounting	Net price excl. VAT	EUR
3160-	rooted base		451
3260-	flanged base		513
	Powder coating 6,8 meter column, see codes below		304

4.8 meter galvanised column for Multiple Nyx, 3 m conical with 1.8 m cylindrical extender			
Product code	Mounting	Net price excl. VAT	EUR
3162-	rooted base		356
3262-	flanged base		423
	Powder coating 4,8 meter column, see codes below		226

For 2 mid-column and 1 top-post lantern



5 meter galvanised column for Multiple Nyx, 3.5 m conical with 1.5 m cylindrical extender			
Product code	Mounting	Net price excl. VAT	EUR
3164-	rooted base		435
3264-	flanged base		423
	Powder coating 5 meter column, see codes below		226

For 1 mid-column and 1 top-post lantern

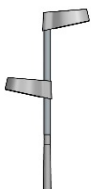

5 meter galvanised column for Multiple Nyx, 4 m conical with 1 m cylindrical extender			
Product code	Mounting	Net price excl. VAT	EUR
3163-	rooted base		392
3263-	flanged base		451
	Powder coating 5 meter column, see codes below		226

4 meter galvanised column for Multiple Nyx, 3 m conical with 1 m cylindrical extender			
Product code	Mounting	Net price excl. VAT	EUR
3161-	rooted base		310
3261-	flanged base		372
	Powder coating 4 meter column, see codes below		189

Powder coat

Select colour and form the product code as shown below. The digit 7 for galvanising is replaced by the colour code.	
Colour code columns	The above prices apply to RAL colours and the following Focus standard colours:
3 = black RAL 9005	
4 = graphite grey	
7 = galvanised	
9 = silver grey	
17 = corten brown	
66 = schwarz noir 900	
Example Order code: 3162-7 = 4.8 m column for embedment, galvanised	

OPTIONAL COMPONENTS

Product code	Type	Net price excl. VAT	EUR
50200	Rooted base Ø 108-140 mm		24
50201	Top closing for 60 mm column, grey		4
50205	Top closing for 60 mm column, black		4
98158	Fuse box for 2 Neozed fuses up to 16 A		34

We grant no discount on columns and OCP components

COLUMNS FOR TURN

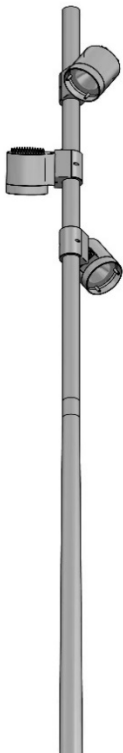

4 m column: 3 m conical + 1 m cylindrical rod Ø76 mm - for two fittings			
Product code	Mounting	Net price excl. VAT	EUR
3170-	rooted base		365
3270-	flanged base		434
	Powder coating 4 meter column, see codes below		189

5.5 m column: 3.5 m conical + 2 m cylindrical rod Ø76 mm - for three fittings			
Product code	Mounting	Net price excl. VAT	EUR
3172-	rooted base		459
3272-	flanged base		526
	Powder coating 5,5 meter column, see codes below		261

7 m column: 3.8 m conical + 3.2 m cylindrical rod Ø76 mm - for three or more fittings			
Product code	Mounting	Net price excl. VAT	EUR
3174-	rooted base		504
3274-	flanged base		577
	Powder coating 7 meter column, see codes below		304

Select colour and form the product code as shown below. The digit 7 for galvanising is replaced by the colour code.			
Colour code columns	The above prices apply to RAL colours and the following Focus standard colours:		
4 = graphite grey			
7 = galvanised			
9 = silver grey			
17 = corten brown			
66 = schwarz noir 900			
Other RAL colours are coded in connection with quote or order.			
Example Order code: 3172-17 = 5.5 m column for embedment, corten brown			

Options	Type	Net price excl. VAT	EUR
1714-1	Adapter for Ø 60 mm rod		40
50200	Rooted base Ø 108-140 mm		24
50206	Top closing Ø76 pole, grey		5
50207	Top closing Ø76 pole, black		5
98158	Fuse box for 2 Neozed fuses up to 16 A		34
50271	Fuse box for 3 Neozed fuses up to 16 A		94

7 m and 5.5 m post:

We grant no discount on columns and optional items.

**SPACE & SKY
COLUMNS**



Conical, galvanised column Ø 90 mm with Ø 60 / H 100 top pipe			
Varenummer	Højde	Net price excl. VAT	EUR
3350-7	3 meter, rooted base		356
3450-7	3 meter, flanged base		420
	Powder coating 3 meter column, see codes below		177
3351-7	3.5 meter, rooted base		364
3451-7	3.5 meter, flanged base		430
	Powder coating 3.5 meter column, see codes below		185
3352-7	4 meter, rooted base		373
3452-7	4 meter, flanged base		438
	Powder coating 4 meter column, see codes below		189
3353-7	4.5 meter, rooted base		383
3453-7	4.5 meter, flanged base		447
	Powder coating 4.5 meter column, see codes below		207

Cylindrical, galvanised column Ø 90 mm with Ø 60 / H 100 top pipe			
Product code	Height	Net price excl. VAT	EUR
3150-	3 meter, rooted base		367
3250-	3 meter, flanged base		431
	Powder coating 3 meter column, see codes below		177
3151-	3.5 meter, rooted base		383
3251-	3.5 meter, flanged base		447
	Powder coating 3.5 meter column, see codes below		185
3152-	4 meter, rooted base		399
3252-	4 meter, flanged base		463
	Powder coating 4 meter column, see codes below		189
3153-	4.5 meter, rooted base		400
3253-	4.5 meter, flanged base		466
	Powder coating 4.5 meter column, see codes below		207
50202	Rooted base Ø 62-90 mm		24
8016-	Connection ring for 90 mm column		13

Powder coat

Select colour and form the product code as shown below. The digit 7 for galvanising is replaced by the colour code.	
Colour code columns	
4 = graphite grey	
7 = galvanised	
9 = silver grey	
17 = corten brown	
66 = black noir 900	
Other RAL colours are coded in connection with quote or order.	
Example Order code: 3152-66 = 4 meter Ø 90 mm column, noir 900	

Fuse box for Ø 90 mm column			
Product code	Type	Net price excl. VAT	EUR
6949	DI Euro Mini, max 2 of 4 x 16 mm ² , class II		48
6949-J	DI Euro Mini, max 2 of 5 x 10 mm ² , class I		48
50279	Nipa HSW 1194, max 2 of 5 x 6 mm ²		64

Fuse box for Ø 90 mm conical column			
Product code	Type	Net price excl. VAT	EUR
98158	Fuse box for 2 Neozed fuses up to 16 A		34
50271	Fuse box for 3 Neozed fuses up to 16 A, conical: min 4 m high		94

We grant no discount on columns and OCP components

COLUMNS

Galvanised standard columns

Product code	Height	Net price excl. VAT	EUR
5130-7	3 meter conical column, rooted base		258
5230-7	3 meter conical column, flanged base		334
	Powder coating 3 meter column, see codes below		177
5135-7	3.5 meter conical column, rooted base		265
5235-7	3.5 meter conical column, flanged base		348
	Powder coating 3.5 meter column, see codes below		185
5140-7	4 meter conical column, rooted base		289
5240-7	4 meter conical column, flanged base		372
	Powder coating 4 meter column, see codes below		189
5150-7	5 meter conical column, rooted base		334
5250-7	5 meter conical column, flanged base		426
	Powder coating 5 meter column, see codes below		226
5160-7	6 meter conical column, rooted base		389
5260-7	6 meter conical column, flanged base		469
	Powder coating 6 meter column, see codes below		261
5170-7	7 meter conical column, rooted base		443
5270-7	7 meter conical column, flanged base		539
	Powder coating 7 meter column, see codes below		304

POWDER COATING

Select colour and form the product code as shown below. The digit 7 for galvanising is replaced by the colour code.	
Colour code columns	
3 = black RAL 9005	
4 = graphite grey	
9 = silver grey	
17 = corten brown	
66 = black noir 900	
Other RAL colours are coded in connection with quote or order.	
Example product code: 5150-4 = 5 meter conical column, rooted base, graphite grey	

We grant no discount on columns and OCP components

ADDITIONAL EQUIPMENT

	Product code	Description	Net price excl. VAT	EUR
Fuse box	98158	Fuse box for 2 Neozed fuses up to 16 A		34
	50271	Fuse box for 3 Neozed fuses up to 16 A, conical: min 4 m high		94
	50280	Class II, 10 kV surge protection, conical: min 4 m high		97
	50279	Class II, 1 fuse, Nipa Mini, max 2 of 5 x 6 mm ²		64
	6949	Class II, 1 fuse, DI Euro Mini, max 2 of 4 x 16 mm ²		48
	6949-J	Class I, 1 fuse, DI Euro Mini, max 2 of 5 x 16 mm ²		48
Cable entry	50100	Cable entry		7
Cable sleeve	50204	Cable sleeve, black, for 152 x 57 mm hole		7
Top closure	50201	Top closure for Ø60 column, grey (also available in black)		4
	50206	Top closure for Ø76 column, grey (also available in black)		5
Wing base	50200	Nipa wing base Ø108-140 column		24
	50202	Nipa wing base Ø62-90 column		24
	50208	Nipa wing base Ø141-200 column		24
Concrete base	50301	Nipa concrete base		215
Ring-shaped base	50276	DanIntra ring-shaped base		102

We grant no discount on columns and OCP components

Colour codes

Powder coating	Akzo Nobel
Graphite grey	YW355F, D2525
Silver grey	Y2370I, D2525
Black	RAL 9005, SN805G
Black noir 900	Noir 900 Sablé, SN351F
White	RAL 9010 Textura, SA310G
Corten brown	YX355F, D2525

Wet coating	
Alu	RAL 9006
Graphite grey	MO125, Esbjerg Lak og Farver
White	RAL 9010, shine 30
Black	RAL 9005, shine 30